

Address 2
Address 1

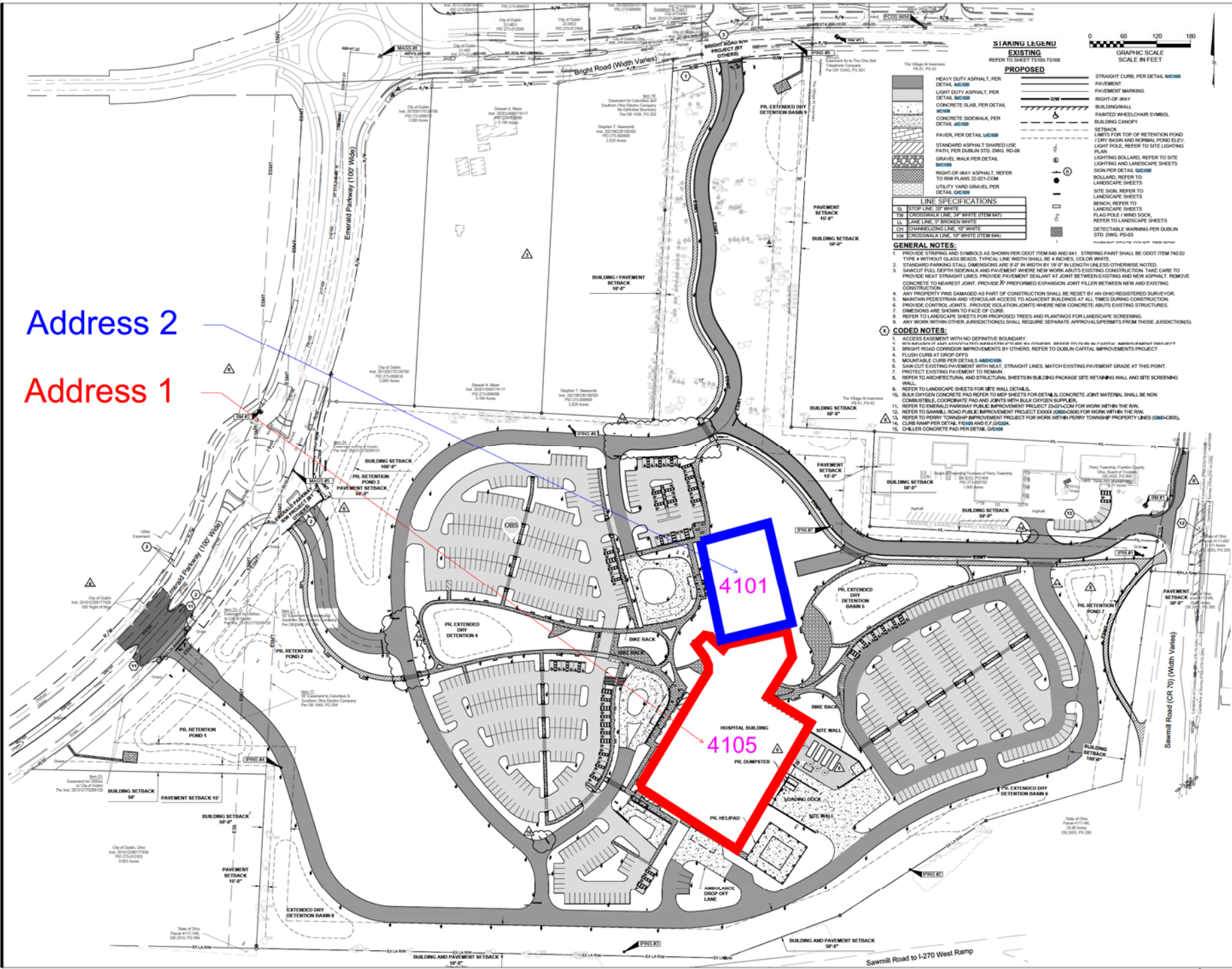

STAKING LEGEND
REFER TO SHEET TS100-TS106

EXISTING

PROPOSED

HEAVY DUTY ASPHALT, PER DETAIL AC108

LIGHT DUTY ASPHALT, PER DETAIL AC108

CONCRETE SLAB, PER DETAIL AC108

CONCRETE SIDEWALK, PER DETAIL AC108

PAVER, PER DETAIL AC108

STANDARD ASPHALT SHARED USE PATH, PER DUBLIN STD. DWG. PD-306

GRAVEL WALK PER DETAIL AC108

RIGHT-OF-WAY ASPHALT, REFER TO RW PLANS 22-021-COM

UTILITY YARD GRAVEL, PER DETAIL GC108

LINE SPECIFICATIONS

SL	STREET LINE, 12" WHITE
CL	CROSSWALK LINE, 24" WHITE (ITEM 647)
LL	LANE LINE, 12" BROKEN WHITE
CH	CHANGELINE, 12" WHITE
SW	CROSSWALK LINE, 12" WHITE (ITEM 644)

GENERAL NOTES:

- PROVIDE STAKING AND SYMBOLS AS SHOWN PER COOT ITEM 640 AND 641. STAKING PAINT SHALL BE COOT ITEM 640 52 TYPE 4 WITHOUT GLASS BEADS. TYPICAL LINE WIDTH SHALL BE 4 INCHES, COLOR WHITE.
- STANDARD PARKING STALL DIMENSIONS ARE 12' 0" IN WIDTH BY 19' 0" IN LENGTH UNLESS OTHERWISE NOTED.
- SAW-CUT FULL DEPTH SIDEWALK AND PAVEMENT WHERE NEW WORK ADJACENT TO EXISTING CONSTRUCTION. TAKE CARE TO PROVIDE NEAT STRAIGHT LINES. PROVIDE PAVEMENT SEALANT AT JOINT BETWEEN EXISTING AND NEW ASPHALT. REMOVE CONCRETE TO NEAREST JOINT. PROVIDE PREFORMED EXPANSION JOINT FILLER BETWEEN NEW AND EXISTING CONSTRUCTION.
- ANY PROPERTY DAMAGED AS PART OF CONSTRUCTION SHALL BE RESEED BY AN Ohio REGISTERED SURVEYOR.
- MAINTAIN PEDESTRIAN AND VEHICULAR ACCESS TO ADJACENT BUILDINGS AT ALL TIMES DURING CONSTRUCTION.
- PROVIDE CONTROL JOINTS. PROVIDE ISOLATION JOINTS WHERE NEW CONCRETE ADJUTS EXISTING STRUCTURES.
- DIMENSIONS ARE SHOWN TO FACE OF CURB.
- REFER TO LANDSCAPE SHEETS FOR PROPOSED TREES AND PLANTINGS FOR LANDSCAPE SCREENING.
- ANY WORK WITHIN OTHER JURISDICTIONS SHALL REQUIRE SEPARATE APPROVALS FROM THOSE JURISDICTIONS.

CODED NOTES:

- ACCESS EASEMENT WITH NO DEFINITIVE BOUNDARY.
- ANY MATERIAL LAY AND ASSOCIATED IMPROVEMENTS BY OTHERS. REFER TO PERMITS FOR PARTIAL ABANDONMENT PROJECTS.
- BRIGHT ROAD CORRIDOR IMPROVEMENTS BY OTHERS. REFER TO DUBLIN CAPITAL IMPROVEMENTS PROJECT.
- FLUSH CURB AT DROP OFF.
- MOUNTABLE CURB PER DETAIL AC108
- SAW-CUT EXISTING PAVEMENT WITH NEAT, STRAIGHT LINES. MATCH EXISTING PAVEMENT GRADE AT THIS POINT.
- REFER TO EXISTING PAVEMENT TO REMAIN.
- REFER TO ARCHITECTURAL AND STRUCTURAL SHEETS IN BUILDING PACKAGE SET: RETAINING WALL AND SITE SCREENING WALL.
- REFER TO LANDSCAPE SHEETS FOR SITE WALL DETAILS.
- WALK CYCLON CONCRETE PAD REFER TO MEP SHEETS FOR DETAILS. CONCRETE JOINT MATERIAL SHALL BE NON-COMMUTABLE. COOPERATIVE CONCRETE PAD AND JOINTS WITH BALK CYCLON SUPER.
- REFER TO EMERALD PARKWAY PUBLIC IMPROVEMENT PROJECT 22-021-COM FOR WORK WITHIN THE RW.
- REFER TO SARNELL ROAD PUBLIC IMPROVEMENT PROJECT EX000 (2020-COM) FOR WORK WITHIN THE RW.
- REFER TO PENNY TOWNSHIP IMPROVEMENT PROJECT FOR WORK WITHIN PENNY TOWNSHIP PROPERTY LINES (2020-COM).
- CURB RAMP PER DETAIL FIGS AND E.F. 0204.
- CHILDREN CONCRETE PAD PER DETAIL, GC108

HGA
333 East Erie Street
Milwaukee, Wisconsin 53202
Telephone 414.278.8200

KORDA
KORDA NEMETH ENGINEERING
CIVIL/MECHANICAL/ELECTRICAL/
PLUMBING/STRUCTURAL/
TECHNOLOGY ENGINEER

KORDA
1620 WATERMARK DRIVE
COLUMBUS, OH 43215
614.487.9500

MKSK
LANDSCAPE ARCHITECT

MKSK
462 SOUTH LUELLIN ALLEY
COLUMBUS, OH 43215
614.621.2796

MOUNT CARMEL HEALTH SYSTEM

MOUNT CARMEL
NORTHWEST HEALTH CAMPUS
4105 EMERALD PARKWAY
DUBLIN, OH



NO	DESCRIPTION	DATE
3	AS1-003	03/17/2023
6	AS1-006	03/20/2023
8	AS1-008	03/20/2023
9	AS1-009	03/20/2023
12	AS1-012	03/20/2023
16	AS1-016	12/06/2023

HGA NO: 1927-004-00

OVERALL SITE STAKING PLAN

DATE: MARCH 17, 2023
SITE ENGINEERING PACKAGE

C102

SITE ENGINEERING PACKAGE