

Franklin County Auditor Map view

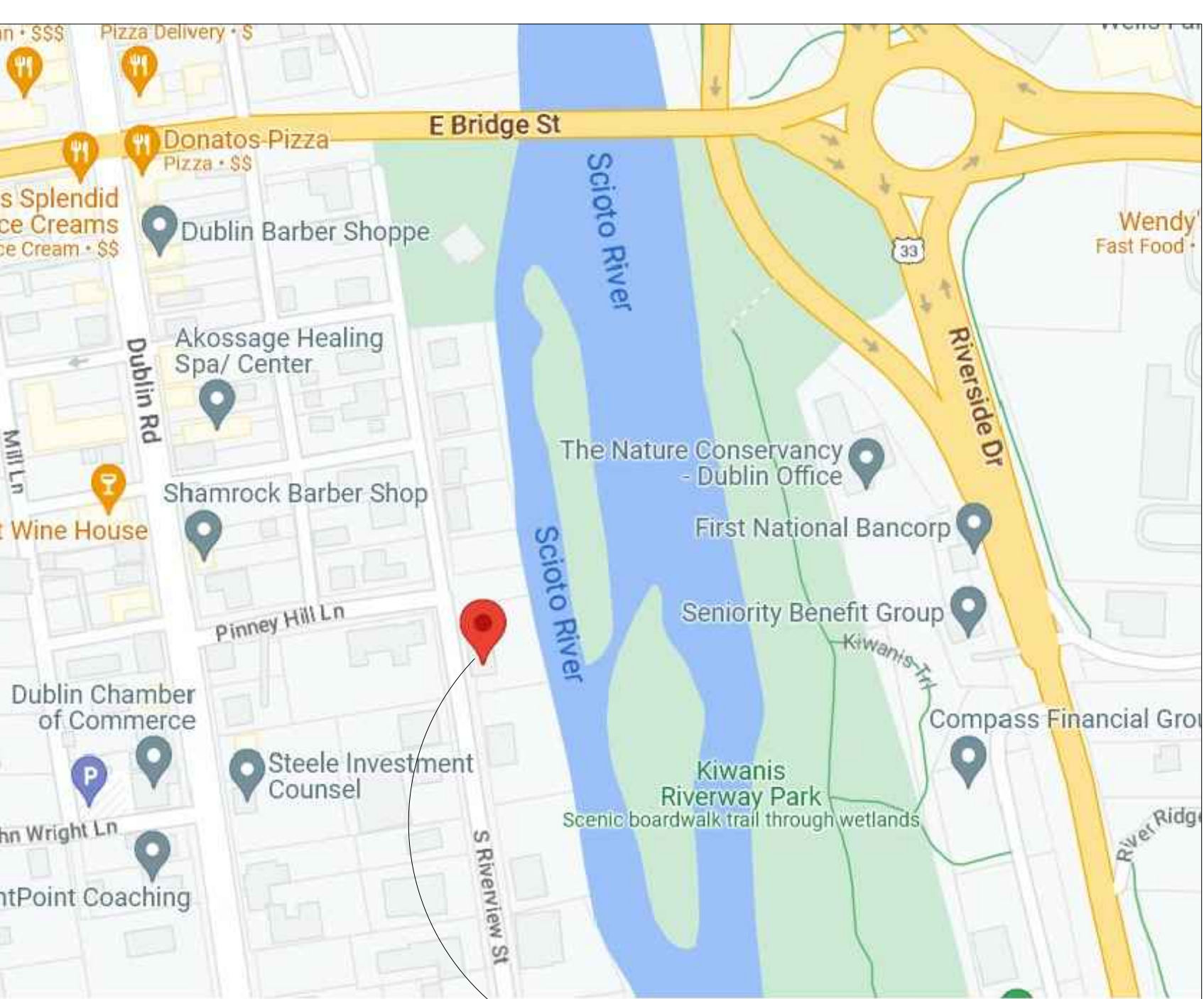

Project Location

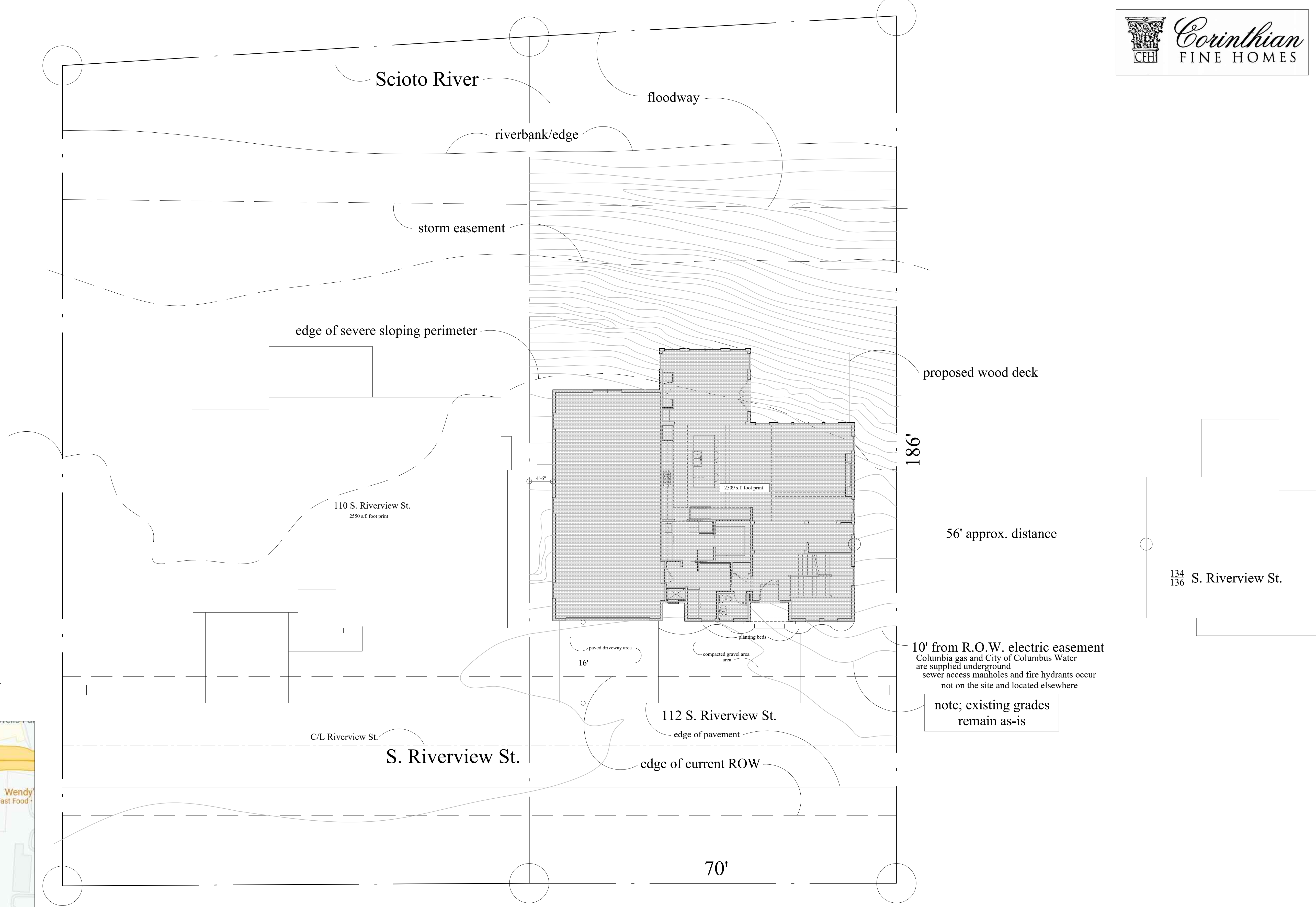

Dublin historic guidelines site development stds. based on Dublin code 153.173		112 S. Riverview Dr. lot coverage one dwelling unit	
minimum lot size 8,700 s.f.	_____	11,439 s.f. (.26 acres)	_____
minimum lot width 60 ft.	_____	70'	_____
front yard setback 0'	_____	16' from exist. rd. pavement	_____
min. side yard setback 3'	_____	4'-6"	_____
min. side yard setback total 12'	_____	11'-0"	_____
rear yard setback 20% lot depth max 50'	_____	65% avg.	_____
maximum lot coverage 45%	_____	26 %	_____
maximum build ht. 24'	_____	21'-3" (center roof street elevation)	_____
maximum building footprint 25%	_____	21% (2509 s.f. building footprint)	_____
attached front loaded setback 20'	_____	16' (waiver requested)	_____
front loaded garage setback <35% linear distance front elevation	_____	34%	_____

Site plan/ data
scale 1" = 20'-0"

Razor residence, 112 S. Riverview St.