

Legend	
x708.00	Spot Elevation
TC	Top of Curb
Line Types	
---XXI---	Existing Contours
---XXS---	Existing Property Line
---	Existing R/W Line
---	Existing R/W Centerline
⊕---	Existing Centerline of Road
---	Existing Easement Line
---	Subdivision Boundary Line
---	Lot Line
---	R/W Line
---	R/W Centerline
⊕---	Centerline of Road
---	Easement Line

**SECTION 3 SITE STATISTICS:**

TOTAL ACREAGE:	±4.206 ACRES
RIGHT-OF-WAY ACREAGE:	±0.494 ACRES
LOT 3 ACREAGE:	±1.726 ACRES
LOT 4 ACREAGE:	±1.986 ACRES
NUMBER OF LOTS:	2
GROSS DENSITY:	
LOT 3 (34 Units):	±19.7 UNITS/ACRE
LOT 4 (32 Units):	±16.1 UNITS/ACRE

**OVERALL SITE STATISTICS:**

OPEN SPACE:	
REQUIRED:	154 UNITS ACROSS ALL FOUR BLOCKS 154 UNITS X 200 SF/UNITS = 30,800 SF (0.71 ACRES)
PROVIDED:	
SECTION 3:	OPEN SPACE C1: 0.124 ACRES OPEN SPACE C2: 0.031 ACRES OPEN SPACE D1: 0.045 ACRES TOTAL: 0.200 ACRES

ZONING CLASSIFICATION: BSD-SCN

**VERTICAL DATUM**

The Vertical Datum is based on the elevation established by the Franklin County Engineering Department, at monument FRANK 73, being 801.706 feet in elevation. The elevation was transferred from said Franklin County Engineering Department monuments using static GPS procedures (03Geoid) and differential leveling to the site. Monument N45, being 826.994 feet in elevation, and monument A5, being 850.413 feet in elevation were used as vertical checks. The said monuments being source bench marks with elevations that are based on the North American Vertical Datum of 1988.

**BENCH MARKS**  
(NAVD 1988)

BM#58	Chiseled 'X' on the west flange bolt of a fire hydrant located on the east side of Village Parkway, being the first fire hydrant south of the intersection with Tuller Road.	Elev. = 890.38
BM#59	Chiseled 'X' on the north flange bolt of a fire hydrant located on the south side of Tuller Road, being the first fire hydrant west of the intersection with Village Parkway.	Elev. = 882.63
BM#60	Chiseled 'X' on the north flange bolt of a fire hydrant located on the south side of Tuller Road, being the second fire hydrant west of the intersection with Village Parkway.	Elev. = 877.70
BM#61	Chiseled 'X' on the north flange bolt of a fire hydrant located on the south side of Tuller Road, being the third fire hydrant west of the intersection with Village Parkway.	Elev. = 872.06

**HORIZONTAL DATUM**

The coordinates shown on this map are based on the Ohio State Plane Coordinate System, South Zone, NAD 83 (1986). Said coordinates originated from a field traverse which was tied (referenced) to said coordinate system by GPS observations of Franklin County Engineering Department monuments FRANK 73, and FRANK 74. The grid to ground scale factor (1.00001917996982) was applied at the location of monument FRANK 73 (N765366.163, E1797820.341).

Points	Northing (Ground)	Easting (Ground)	Description
108	768221.307	1799666.128	1165 (aka 1008 20171144) MAGS
151	767591.481	1801063.461	1152 IPS w/ Cap
169	767743.871	1801141.293	1165 (aka 5009 20142037) MAGS
257	768244.644	1801049.937	1152 GPS IPS w/ Cap

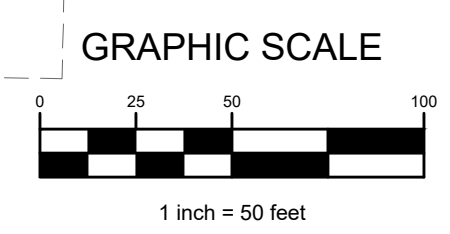

REVISIONS	
DATE	DESCRIPTION

**EMHT**  
Evans, Mechwart, Hamilton & Titon, Inc.  
Engineers • Surveyors • Planners • Scientists  
5307 New Albany Road, Columbus, OH 43054  
Phone: 614.755.4500 Toll Free: 888.775.3448  
emht.com

PULTE HOMES  
475 METRO PLACE  
DUBLIN, OHIO 43017  
PH: (614) 376-1000

CITY OF DUBLIN, FRANKLIN COUNTY, OHIO  
PRELIMINARY PLAT- SECTION 3  
FOR  
**TOWNS ON THE PARKWAY**  
SITE PLAN

LOCATED IN:  
QUARTER TOWNSHIP 2, TOWNSHIP 2, RANGE 19  
UNITED STATES MILITARY LANDS  
CITY OF DUBLIN, COUNTY OF FRANKLIN, STATE OF OHIO

Date	Job No.
OCTOBER, 2023	20210247
Scale	Sheet
1"=50'	3/7















Tree ID	Common Name	Scientific Name	DBH (in)	Trunks	Condition
1	Swamp White Oak	Quercus bicolor	11	1	Good
2	Bur Oak	Quercus macrocarpa	16	1	Good
3	White Oak	Quercus alba	18	1	Good
4	Chestnut Oak	Quercus prinus	11	1	Fair
5	Bur Oak	Quercus macrocarpa	18	1	Good
6	Bur Oak	Quercus macrocarpa	19	1	Good
7	Bur Oak	Quercus macrocarpa	17	1	Good
8	Bur Oak	Quercus macrocarpa	15	1	Good
9	Bur Oak	Quercus macrocarpa	21	1	Good
10	Swamp White Oak	Quercus bicolor	15	1	Poor
11	Swamp White Oak	Quercus bicolor	11	1	Fair
12	Bur Oak	Quercus macrocarpa	12	1	Good
13	Bur Oak	Quercus macrocarpa	14	1	Good
14	Bur Oak	Quercus macrocarpa	15	1	Good
15	Bur Oak	Quercus macrocarpa	12	1	Good
16	Swamp White Oak	Quercus bicolor	10	1	Good
17	Bur Oak	Quercus macrocarpa	15	1	Good
18	Bur Oak	Quercus macrocarpa	16	1	Good
19	Swamp White Oak	Quercus bicolor	13	1	Good
20	English Oak	Quercus robur	14	1	Good
21	Bur Oak	Quercus macrocarpa	15	1	Good
22	Bur Oak	Quercus macrocarpa	12	1	Good
23	Bur Oak	Quercus macrocarpa	20	1	Good
24	Bur Oak	Quercus macrocarpa	16	1	Good
25	Swamp White Oak	Quercus bicolor	12	1	Fair
26	Bur Oak	Quercus macrocarpa	11	1	Good
27	Bur Oak	Quercus macrocarpa	15	1	Good
28	Crabapple-sp.	Malus-sp.	7	1	Dead
29	Crabapple-sp.	Malus-sp.	12	1	Poor
30	Crabapple-sp.	Malus-sp.	12	1	Poor
31	Crabapple-sp.	Malus-sp.	8,5	2	Poor
32	Crabapple-sp.	Malus-sp.	8,6	2	Poor
33	American Basswood	Tilia americana	13,5	1	Good
34	Norway Spruce	Picea abies	15	1	Fair
35	Bradford Pear	Pyrus calleryana	6	1	Good
36	American Plum	Prunus americana	6,5,6,2	4	Good
37	Green-Ash	Fraxinus pennsylvanica	8,6,4	3	Fair
38	Eastern Cottonwood	Populus deltoides	25	1	Good
39	Sycamore	Platanus occidentalis	8,6,6	3	Good
40	Green-Ash	Fraxinus pennsylvanica	12,10,6	3	Poor
41	Austrian-Pine	Pinus nigra	10,5	2	Poor
42	Austrian-Pine	Pinus nigra	16	1	Poor
43	Austrian-Pine	Pinus nigra	14	1	Poor
44	Austrian-Pine	Pinus nigra	7,6	2	Poor
45	American Basswood	Tilia americana	12,12	2	Good
46	American Basswood	Tilia americana	21	1	Good
47	Silver Maple	Acer saccharinum	9	1	Fair
48	Silver Maple	Acer saccharinum	17	1	Fair
49	Silver Maple	Acer saccharinum	9	1	Fair
50	American Basswood	Tilia americana	14	1	Good

51	American Basswood	Tilia americana	14	1	Good
52	American Basswood	Tilia americana	13	1	Good
53	American Basswood	Tilia americana	13	1	Good
54	American Basswood	Tilia americana	16	1	Good
55	American Basswood	Tilia americana	13	1	Good
56	American Basswood	Tilia americana	13	1	Good
57	Austrian-Pine	Pinus nigra	13,5	1	Poor
58	Austrian-Pine	Pinus nigra	12	1	Poor
59	Austrian-Pine	Pinus nigra	12	1	Poor
60	Austrian-Pine	Pinus nigra	13	1	Poor
61	Black Cherry	Prunus serotina	6	1	Fair
62	Austrian-Pine	Pinus nigra	8	1	Poor
63	Austrian-Pine	Pinus nigra	7,6	2	Poor
64	American Basswood	Tilia americana	15	1	Good
65	Austrian-Pine	Pinus nigra	12	1	Poor
66	American Basswood	Tilia americana	15	1	Good
67	American Basswood	Tilia americana	12	1	Poor
68	American Basswood	Tilia americana	13	1	Good
69	Bradford Pear	Pyrus calleryana	7	1	Good
70	American Basswood	Tilia americana	11	1	Fair
71	Sugar Maple	Acer saccharum	3,5	1	Good
72	Sugar Maple	Acer saccharum	3	1	Good
73	Sugar Maple	Acer saccharum	2,5	1	Good
74	Sugar Maple	Acer saccharum	3	1	Good
75	Sugar Maple	Acer saccharum	3	1	Good
76	Sugar Maple	Acer saccharum	2,5	1	Good
77	Sugar Maple	Acer saccharum	3	1	Good
78	Sugar Maple	Acer saccharum	3	1	Good
79	Sugar Maple	Acer saccharum	3,5	1	Good
80	Sugar Maple	Acer saccharum	3	1	Good
81	Sugar Maple	Acer saccharum	3	1	Good
82	Sugar Maple	Acer saccharum	4	1	Good
83	Sugar Maple	Acer saccharum	3	1	Good
84	American Plum	Prunus americana	12	1	Poor
85	American Plum	Prunus americana	10	1	Poor
86	Sugar Maple	Acer saccharum	3,5	1	Good
87	Sugar Maple	Acer saccharum	3,5	1	Good
88	Sugar Maple	Acer saccharum	3	1	Good
89	Sugar Maple	Acer saccharum	3,5	1	Good
90	Austrian Pine	Pinus nigra	18	1	Fair
91	Austrian-Pine	Pinus nigra	13	1	Poor
92	Austrian-Pine	Pinus nigra	12	1	Poor
93	Austrian-Pine	Pinus nigra	11	1	Poor
94	Sugar Maple	Acer saccharum	3,5	1	Good
95	Sugar Maple	Acer saccharum	3,5	1	Good
96	Sugar Maple	Acer saccharum	3	1	Good
97	Sugar Maple	Acer saccharum	3,5	1	Good
98	Sugar Maple	Acer saccharum	3	1	Good

TREE REPLACEMENT LEGEND CALCULATIONS:

 TREES TO BE REMOVED

J:\2022\0247\Draw\046\046.mxd Preliminary Plat Section 3, 2022/02/27 - Tree Survey, Removal Plan & Tree Survey Listing Last Saved By: lbragg, 8/18/2022 2:41 PM.

REVISIONS	
DATE	DESCRIPTION



PULTE HOMES  
475 METRO PLACE  
DUBLIN, OHIO 43017  
PH: (614) 376-1000

CITY OF DUBLIN, FRANKLIN COUNTY, OHIO  
PRELIMINARY PLAT- SECTION 3  
FOR  
**TOWNS ON THE PARKWAY**  
TREE SURVEY LIST

LOCATED IN:  
QUARTER TOWNSHIP 2, TOWNSHIP 2, RANGE 19  
UNITED STATES MILITARY LANDS  
CITY OF DUBLIN, COUNTY OF FRANKLIN, STATE OF OHIO

Date	Job No.
OCTOBER, 2023	20210247
Scale	Sheet
	7/7



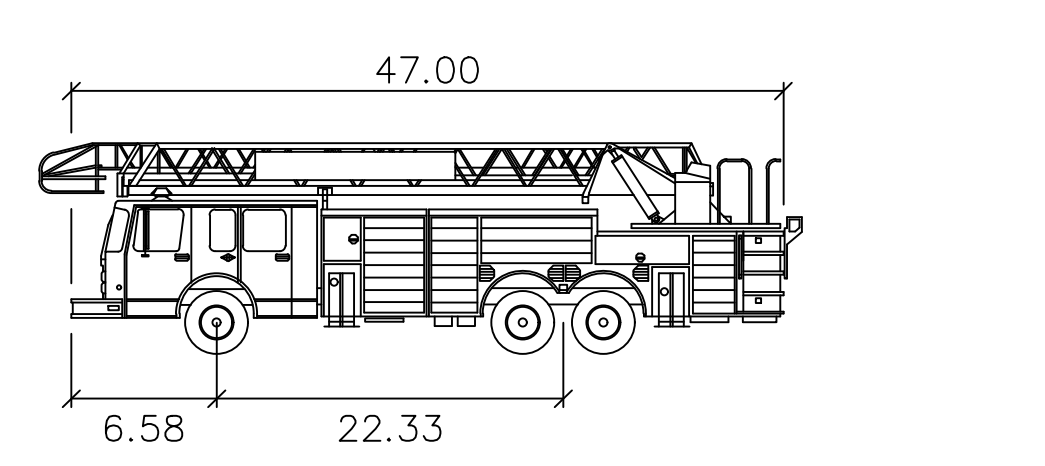
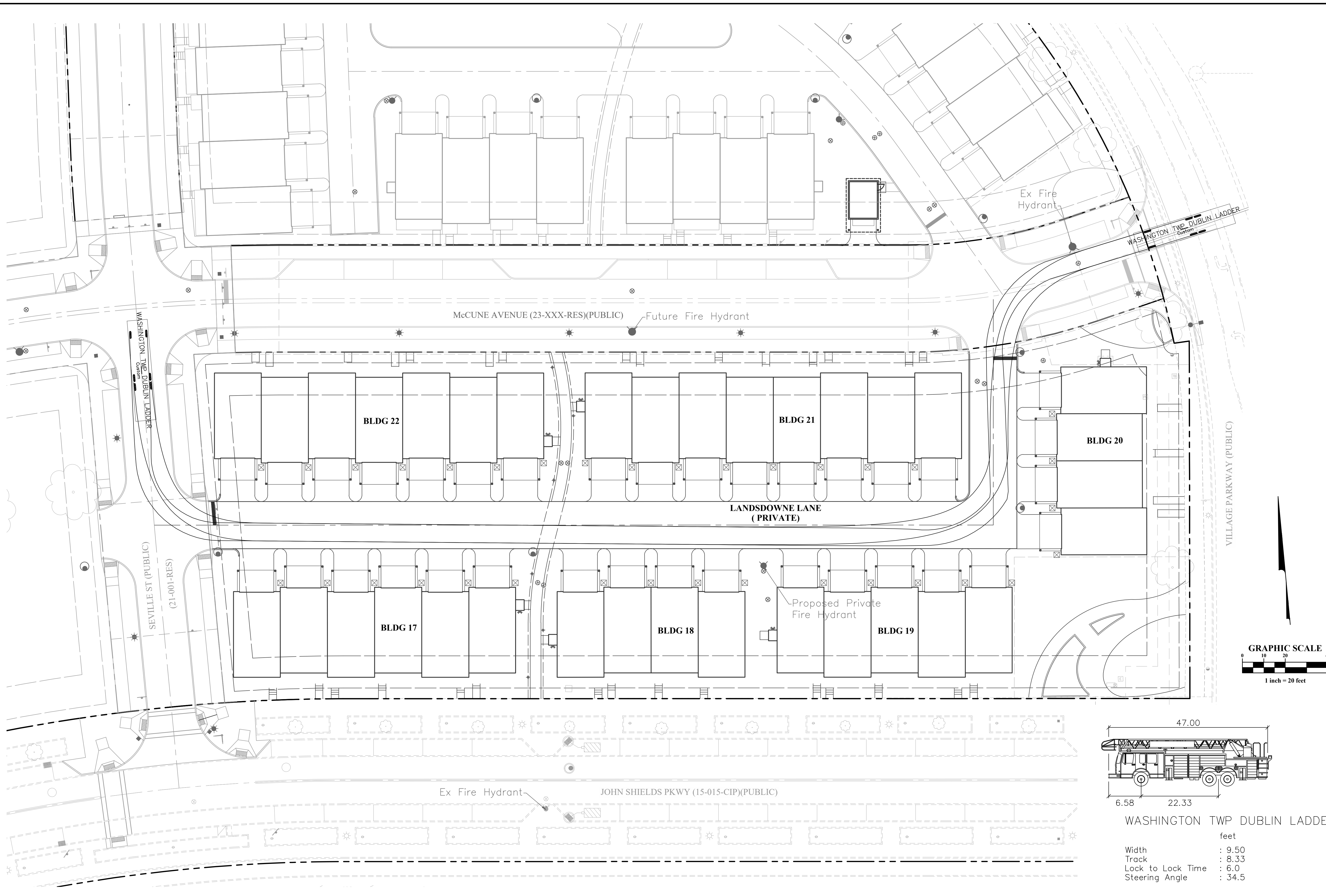

WASHINGTON TWP DUBLIN LADDER

	feet
Width	: 9.50
Track	: 8.33
Lock to Lock Time	: 6.0
Steering Angle	: 34.5

MARK	DATE	DESCRIPTION

REVISIONS

**PRELIMINARY**  
NOT TO BE USED FOR  
CONSTRUCTION

PLAN SET DATE:  
#####

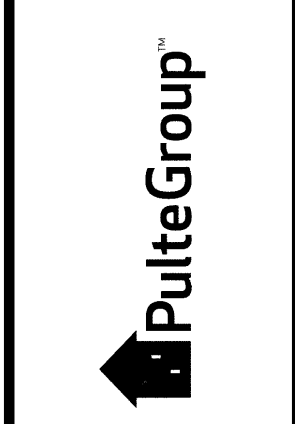

CITY OF DUBLIN, FRANKLIN COUNTY, OHIO  
PRIVATE SITE IMPROVEMENT PLAN  
FOR  
**TOWNS ON THE PARKWAY**  
BLOCK C  
AUTO-TURN EXHIBIT

**EMHT**  
EMH & T, Inc.  
Engineers • Surveyors • Planners • Scientists  
500 New Albany Road, Columbus, OH 43254  
Phone: 614.775.5500 Fax: 614.775.3646  
emht.com

DATE	April 2022
SCALE	1" = 20'
JOB NO.	2021-0247
SHEET	1/1