

GENERAL NOTES FOR CONSTRUCTION

1. ALL DIMENSIONS SHALL BE VERIFIED AT THE JOB BY THE GENERAL CONTRACTOR AND EACH SUB-CONTRACTOR AND THE ENGINEER MUST BE NOTIFIED OF ANY DISCREPANCIES WITH DIMENSIONS OR ANY OTHER FIELD CONDITION WHICH IS NOT ACCORDING TO THE DRAWINGS. PRIOR TO PROCEEDING WITH THE WORK, THE ENGINEER MUST BE NOTIFIED OF ANY FIELD CHANGES WHICH AFFECT MEANS OF EGRESS OR ANY OTHER LIFE SAFETY ITEMS WHICH ARE COVERED BY IBC AFTER THE BUILDING PERMIT HAS BEEN ISSUED BY THE GOVERNING PLAN EXAMINING AGENCY. ALL WORK SHALL CONFORM TO ALL APPLICABLE ELECTRICAL AND MECHANICAL BUILDING CODES. FINAL APPROVAL AT THE SITE WITH THE GOVERNING AGENCY'S INSPECTOR IS MANDATORY.
2. THE CONTRACTOR SHALL COORDINATE AND BE RESPONSIBLE FOR SEQUENCING OF THE CONSTRUCTION. THE STRUCTURE IS DESIGNED TO BE SELF-SUPPORTING AND STABLE AFTER THE BUILDING IS FULLY COMPLETED. IT IS THE CONTRACTOR'S SOLE RESPONSIBILITY TO DETERMINE ERECTION PROCEDURE AND SEQUENCE AND TO INSURE THE SAFETY OF THE BUILDING AND ITS COMPONENT PARTS DURING ERECTION. THIS INCLUDES THE ADDITION OF WHATEVER SHORING, SHEETING, TEMPORARY BRACING GUYS OR TIE-DOWNS WHICH MIGHT BE NECESSARY.
3. IT IS THE CONTRACTOR'S SOLE RESPONSIBILITY TO FOLLOW ALL APPLICABLE SAFETY & BUILDING CODES AND REGULATIONS DURING ALL PHASES OF CONSTRUCTION.
4. THESE CONTRACT DOCUMENTS ARE DESIGNED TO MEET THE REQUIREMENTS FOR THE 2013 Ohio Residential Code(ORC).
5. THE CONTRACTOR SHALL VISIT THE SITE PRIOR TO BIDDING TO INSPECT EXISTING FIELD CONDITIONS. THIS CONTRACT SHALL INCLUDE LABOR AND MATERIALS NECESSARY FOR FIELD MODIFICATIONS DUE TO EXISTING CONDITIONS. ANY CONTRACTOR PROPOSED CHANGES OR DEVIATIONS TO THE DESIGN AS SHOWN SHALL BE SUBMITTED THE OWNER.
6. CALL BEFORE YOU DIG!

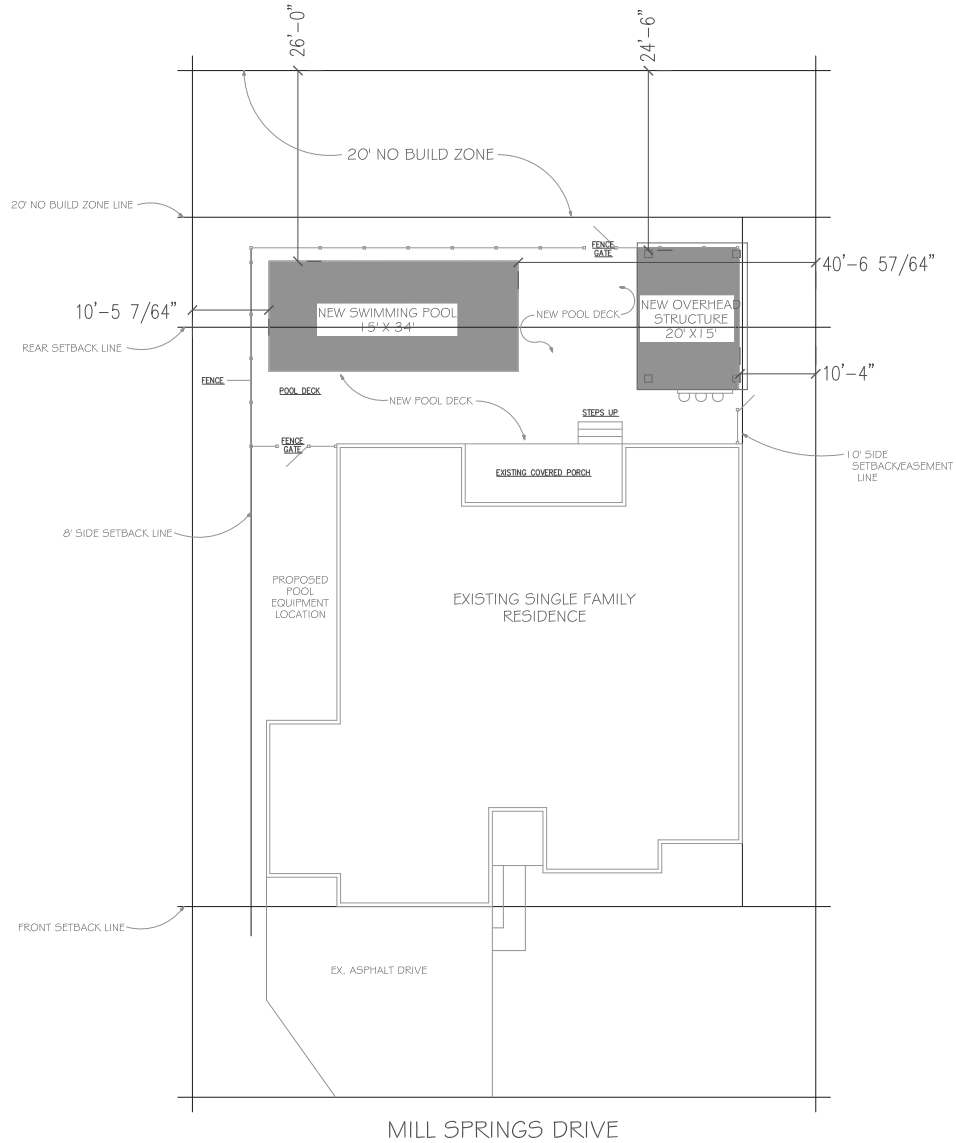

SITE PLAN

General Notes

Project Name and Address
Pool Addition – Dublin, OH
7618 Mill Springs Drive
Dublin, OH 43017

| No. | Revision/Issue | Date |
|-----|----------------|--------|
| 1. | pool placement | 4.3.24 |
| | | |
| | | |

| | |
|-----------------------|--------------|
| Project MSD_2023 | Sheet S.1 |
| Date 01.2023 | |
| Scale 1/8" = 1'-0" | |

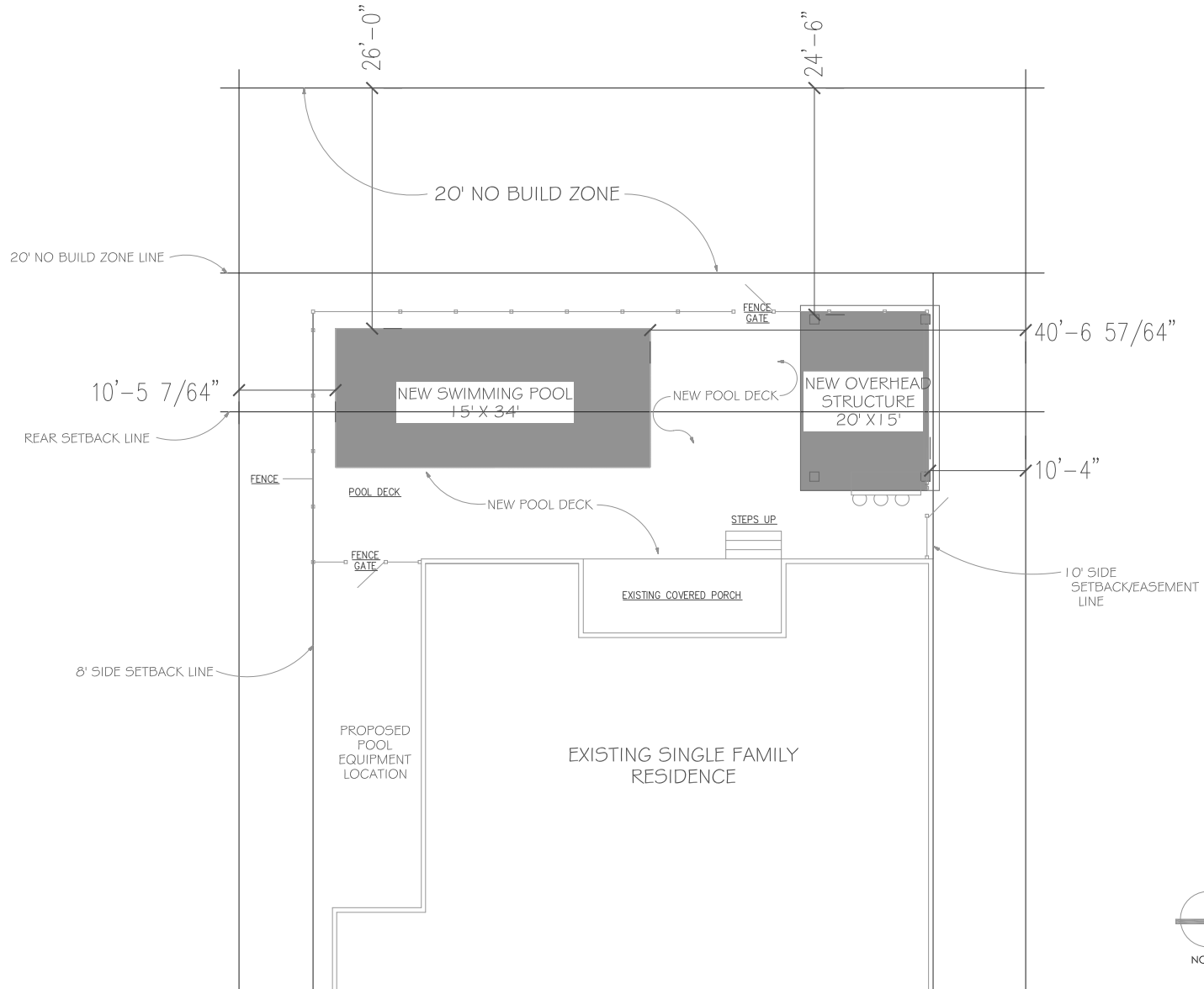

DETAIL SITE PLAN

General Notes

Project Name and Address
 Pool Addition - Dublin, OH
 7618 Mill Springs Drive
 Dublin, OH 43017

| | |
|-------------------|----------------|
| 1. pool placement | 4.3.24 |
| | |
| | |
| No. | Revision/Issue |
| | |

| | |
|------------------------|--------------|
| Project MSD_2023 | Sheet S.2 |
| Date 01.2023 | |
| Scale 3/16" = 1'-0" | |



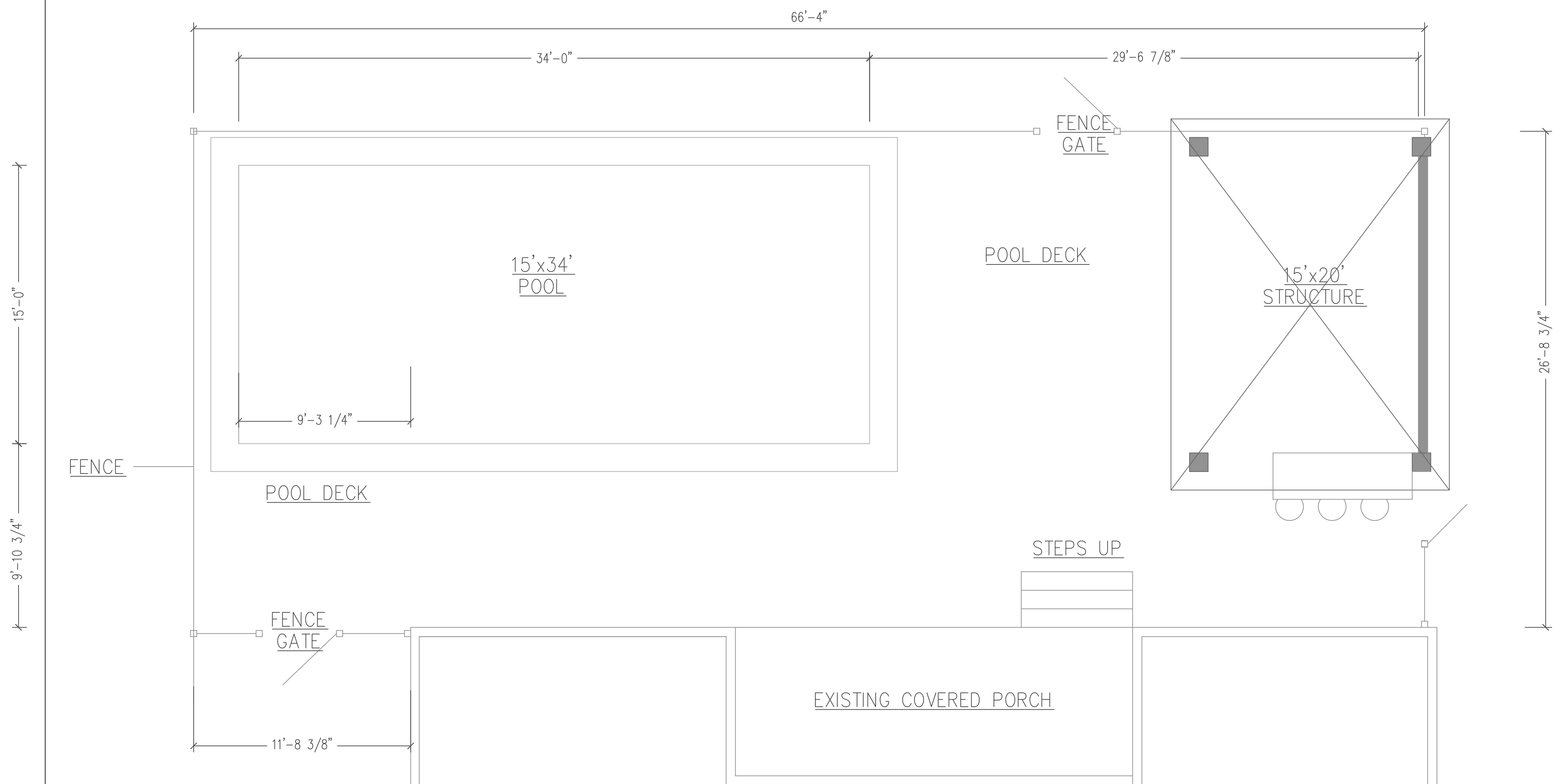

Pool Addition - Layout

General Notes

Project Name and Address
 Pool Addition - Dublin, OH
 7618 Mill Springs Drive
 Dublin, OH 43017

| | | |
|-----|----------------|--------|
| 1. | pool placement | 4.3.24 |
| No. | Revision/Issue | Date |

| | | | |
|---------|--------------|-------|------|
| Project | MSD_2023 | Sheet | L. 1 |
| Date | 01.2023 | | |
| Scale | 1/4" = 1'-0" | | |