

SUPER LUMIDECK FLAT SOFFIT



ALL-WEATHER CANOPIES. AND WE MEAN ALL-WEATHER.

The Super Lumideck Flat Soffit canopy is an all-extruded, pre-engineered canopy designed for high-load architectural applications. The Flat Soffit deck style provides a ceiling aesthetic and achieves a clean, sleek design for any canopy application. The smooth deck can be combined with different fascia profiles to complement any design emphasis or building requirement. Compared to the alternatives, Mapes aluminum, non-rusting finish and high-quality extruded materials provide superior longevity, while meeting all local code requirements for snow and wind loads.

For more details, please visit mapes.com

SUPER LUMIDECK FLAT SOFFIT

TECHNICAL DATA

All-extruded Aluminum (T6 – 6063)

Fascia .125"

Decking .078"

Deflection rating L/180

Maximum Projection*

8' w/ hanger rod supports

5' w/ cantilever supports

Note: Engineered stamped calcs available in all 50 states

*Maximum projection may vary based on load conditions

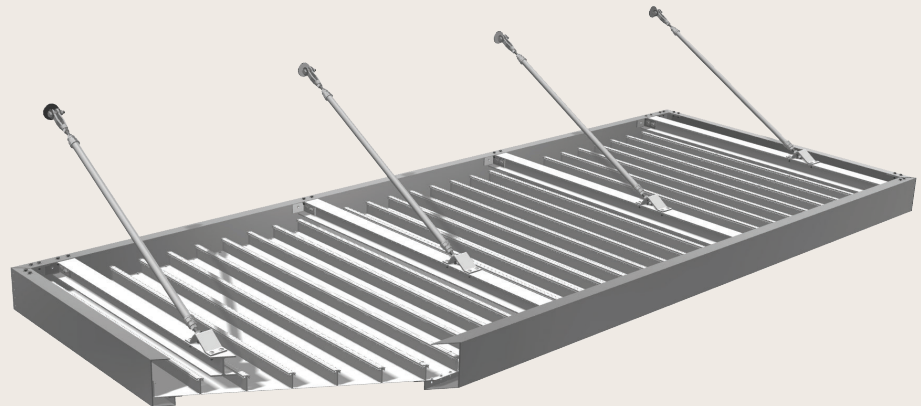

CANOPY DETAILS

Finishes		Warranty		Application
Mapes Standard Finishes	Clear Anodized, White Baked Enamel, & Bronze Baked Enamel	1 year	Meets AAMA 2603 specifications	Factory applied
2-Coat Kynar*	25 stock colors w/ unlimited custom matching options	10 years	70% Fluoropolymer meets AAMA 2605 specifications	Professionally applied & cured by certified finisher

*Additional lead times and costs associated w/ premium paints & custom color matching

FEATURES

- Flat Soffit Decking
- High-load capacity
- Pre-engineered
- All-extruded Aluminum
- Rust & maintenance free
- Custom details & colors
- Pre-assembly options

APPLICATIONS

- Retail Branding
- Shopping Centers
- Storefronts
- Office Buildings

DECK OPTIONS

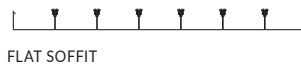

FLAT SOFFIT

FASCIA OPTIONS

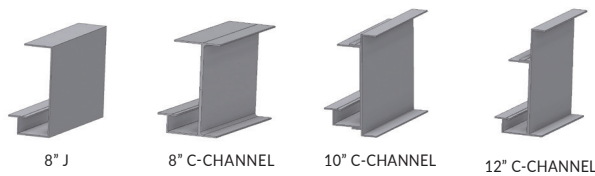

8" J

8" C-CHANNEL

10" C-CHANNEL

12" C-CHANNEL

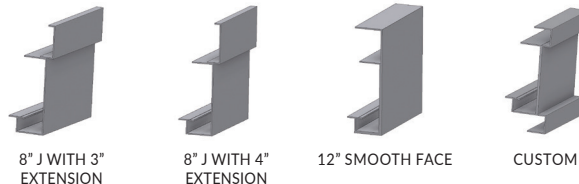

8" J WITH 3" EXTENSION

8" J WITH 4" EXTENSION

12" SMOOTH FACE

CUSTOM

WALL MOUNT DETAILS

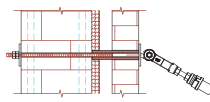

BRICK/BLOCK WITH THRU BOLT AND COMPRESSION SLEEVE

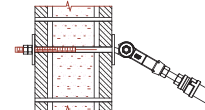

CMU WITH THRU BOLT

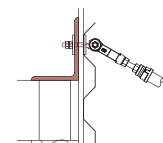

METAL BUILDING

MAPES ARCHITECTURAL CANOPIES

7748 North 56th Street, Lincoln, NE 68514 Phone: 888-273-1132 Fax: 877-455-6572 mapes.com



Mapes Super Lumideck® Flat Soffit Hanger Rod Specifications

Part 1: General

- 1.1 Description of Work
 - A. Work in this section includes furnishing and installation of extruded aluminum overhead hanger rod style canopies as manufactured by Mapes Industries Inc.
 - B. Related Items and Considerations
 - 1. Flashing of various designs may be required. Supplied by the installer.
 - 2. Determine wall construction, make-up and thickness.
 - 3. Ensure adequate wall condition to carry canopy loads where required.
 - 4. Consider water drainage away from canopy where necessary.
 - 5. Any necessary removal or relocation of existing structures, obstructions or materials.
- 1.2 Quality Assurance
 - A. Products meeting these specifications established standard of quality required as manufactured by Mapes Industries, Inc. Lincoln, Nebraska 1-888-273-1132.
- 1.3 Field Measurement
 - A. Confirm dimensions prior to preparation of shop drawings when possible.
 - B. If requested, supply manufacturer's standard literature and specifications for canopies.
 - C. Submit shop drawings showing structural component locations/positions, material dimensions and details of construction and assembly.
- 1.4 Performance Requirements
 - A. Canopy must conform to local building codes.
 - B. Determine if specific load requirements have been established for canopies and if stamped calculations are required for location in which canopy is installed.
 - C. The canopy must handle a minimum of PSF live load.
- 1.5 Deliver, Storage, Handling
 - A. Deliver and store all canopy components in protected areas.

Part 2: Products

- 2.1 Manufacturer
 - A. Mapes Canopies
Lincoln, Nebraska
Phone: 1-888-273-1132.
Fax: 1-877-455-6572.
- 2.2 Materials
 - A. Decking to be 3" extruded flat soffit .078 decking
 - B. Fascia shall be standard 8" extruded "J" style (minimum .125 aluminum)
 - C. Hanger rods and attachment hardware shall be powder coated to match canopy.
 - D. Decking and fascia shall be extruded aluminum, alloy 6063-T6, in profile and thickness shown in current Mapes brochures.

2.3 Finishes

- A. Standard finishes are clear anodized, bronze or white baked enamel.
- B. Optional finishes include standard 2-coat Kynar colors.

2.4 Fabrication

- A. All connections shall be mechanically assembled utilizing 3/16" fasteners with a minimum shear stress of 350 lb. Pre-welded or factory-welded connections are not acceptable.
- B. Decking shall be designed with interlocking extruded aluminum members with mechanical fasteners field applied to provide structural integrity for the completed assembly.
- C. Concealed drainage. Water shall drain from covered surfaces into integral fascia gutter and directed to either the front for front drainage or to the rear for ground level discharge via one or more designated downspouts.

Part 3: Execution

3.1 Inspection

- A. Confirm that surrounding area is ready for the canopy installation.
- B. Installer shall confirm dimensions and elevations to be as shown on drawings provided by Mapes Industries.
- C. Erection shall be performed by an approved installer and scheduled after all concrete, masonry and roofing in the area is completed

3.2 Installation

- A. Installation shall be in strict accordance with manufacturer's shop drawings. Particular attention should be given to protecting the finish during handling and erection.

3.3 After installation, entire system shall be left in a clean condition.