

GENERAL NOTES

THE CITY OF COLUMBUS CONSTRUCTION AND MATERIAL SPECIFICATIONS (CMSC), 2018 EDITION, INCLUDING ALL REVISIONS AND SUPPLEMENT IN EFFECT AT THE TIME OF SIGNATURES BY THE DIRECTOR OF PUBLIC SERVICE, SHALL GOVERN ALL CONSTRUCTION ITEMS THAT ARE A PART OF THIS PLAN UNLESS NOTED OTHERWISE.

ANY MODIFICATION TO THE WORK AS SHOWN ON THESE DRAWINGS MUST HAVE PRIOR WRITTEN APPROVAL BY THE ADMINISTRATOR, DIVISION OF SEWERAGE AND DRAINAGE.

CONSTRUCTION OF THIS PROJECT MAY NOT BEGIN UNTIL THE EASEMENTS INDICATED ARE RECORDED BY THE CITY.

INSPECTION OF THIS PROJECT SHALL BE PROVIDED BY REPRESENTATIVES OF THE CITY OF COLUMBUS. THE DEVELOPER/OWNER SHALL, PRIOR TO ANY CONSTRUCTION OPERATION, DEPOSIT WITH THE CITY THE TOTAL ESTIMATED COST OF INSPECTION AND, WHERE REQUIRED, A REPAVING GUARANTEE.

THE CONTRACTOR SHALL NOTIFY THE DIVISION OF DESIGN AND CONSTRUCTION, CONSTRUCTION SECTION (PHONE 614/645-0433) AND THE DIVISION OF SEWERAGE AND DRAINAGE (PHONE 614/645-7102) - AT LEAST 24 HOURS PRIOR TO CONSTRUCTION.

THE CONTRACTOR SHALL CAREFULLY PRESERVE BENCH MARKS, PROPERTY CORNERS, REFERENCE POINTS, STAKES, AND OTHER SURVEY REFERENCE MONUMENTS OR MARKERS. IN CASE OF WILLFUL OR CARELESS DESTRUCTION, THE CONTRACTOR SHALL BE RESPONSIBLE FOR RESTORATIONS. RESETTling OF MARKERS SHALL BE PERFORMED BY AN OHIO PROFESSIONAL SURVEYOR AS APPROVED BY THE ENGINEER.

ALL TEMPORARY TRAFFIC CONTROL DEVICES SHALL BE FURNISHED, ERECTED, MAINTAINED AND REMOVED BY THE CONTRACTOR IN ACCORDANCE WITH THE "OHIO MANUAL OF UNIFORM TRAFFIC CONTROL DEVICES," COPIES OF WHICH ARE AVAILABLE FROM THE OHIO DEPARTMENT OF TRANSPORTATION, BUREAU OF TRAFFIC, 1980 WEST BROAD STREET, COLUMBUS, OH 43223.

ALL TRAFFIC LANES SHALL BE FULLY OPEN TO TRAFFIC AT ALL EXISTING PUBLIC ROADWAYS.

INGRESS AND EGRESS SHALL BE MAINTAINED AT ALL TIMES TO PUBLIC AND PRIVATE PROPERTY.

NON-RUBBER Tired VEHICLES SHALL NOT BE MOVED ON PUBLIC STREETS, EXISTING PRIVATE ROADWAYS OR PARKING LOTS. NO EXCEPTIONS SHALL BE GRANTED.

THE CONTRACTOR AND SUB-CONTRACTOR SHALL BE SOLELY RESPONSIBLE FOR COMPLYING WITH ALL FEDERAL, STATE, AND LOCAL SAFETY REQUIREMENTS, TOGETHER WITH EXERCISING PRECAUTIONS AT ALL TIMES FOR THE PROTECTION OF PERSONS (INCLUDING EMPLOYEES) AND PROPERTY. IT IS ALSO THE SOLE RESPONSIBILITY OF THE CONTRACTOR AND SUB-CONTRACTOR TO INITIATE, MAINTAIN, AND SUPERVISE ALL SAFETY REQUIREMENTS, PRECAUTIONS AND PROGRAMS IN CONNECTION WITH THE WORK.

IN ADDITION TO DIRECT REQUIREMENTS OF THE CONTRACT SPECIFICATIONS, THE CONTRACTOR SHALL OBSERVE AND CONFORM TO THE SPECIFIC REQUIREMENTS OF ALL RIGHTS-OF-WAY INCLUDING EASEMENTS, COURT ENTRIES, RIGHTS-OF-ENTRY OR ACTION FILED IN COURT IN ACCORDANCE WITH THE CODE OF APPLICABLE GOVERNING AGENCY. THE COST OF THE OPERATIONS NECESSARY TO FULFILL SUCH REQUIREMENTS SHALL BE INCLUDED IN THE PRICE BID FOR THE SANITARY SEWER IMPROVEMENTS.

FEES

THE APPROPRIATE FEES FOR STANDBY INSPECTIONS, SYSTEM CAPACITY, SEWER TAP PERMITS AND DRAINING PERMITS WILL BE PROVIDED BY THE OWNER.

PERMITS

THE CONTRACTOR SHALL OBTAIN ALL NECESSARY PERMITS. AN ORIGINAL PERMIT, WITH RED SIGNATURES, SHALL BE KEPT ON-SITE AT ALL TIMES.

WHEN OCCUPYING OR EXCAVATING WITHIN PUBLIC RIGHT-OF-WAY LIMITS, THE CONTRACTOR SHALL OBTAIN AN EXCAVATION PERMIT FROM THE CITY OF COLUMBUS, DEPARTMENT OF PUBLIC SERVICE - PERMIT OFFICE BETWEEN THE HOURS OF 7:30 AM AND 4:00 PM MONDAY THROUGH FRIDAY. PHONE: (614) 645-7497; FAX (614) 645-1876; EMAIL: COLSPERMITS@COLUMBUS.GOV

SANITARY SEWERS

PIPE SPECIFICATION FOR THE PLAN IMPROVEMENTS SHALL BE IN ACCORDANCE WITH THE FOLLOWING:
- PVC GRAVITY SEWER PIPE ASTM D3034 (SDR-35) FOR 6"-10" DIAMETER PIPE WITH JOINT SPECIFICATIONS AS PER ASTM D3212.

THE CONTRACTOR SHALL PROVIDE WRITTEN CERTIFICATION TO THE ENGINEER REFLECTING THE PIPE MATERIAL TO BE USED ALONG WITH THE CURRENT CITY CONSIGNMENT LIST IDENTIFYING THE APPROVED PIPE MATERIAL SPECIFICATION.

ALL SANITARY SERVICES SHALL BE A MINIMUM OF 2.08% GRADE (1/4" PER FT.) UNLESS OTHERWISE NOTED.

SERVICE RISERS, ITEM 914, SHALL BE INSTALLED WHERE DEPTH FROM THE WYE FITTING TO THE EXISTING OR PROPOSED SURFACE ELEVATION EXCEEDS 10 FEET. TOP OF RISER SHALL BE NO MORE THAN ±9" BELOW THE EXISTING OR PROPOSED SURFACE ELEVATION, WHICHEVER IS HIGHER.

THE CONTRACTOR SHALL FURNISH AND PLACE WYE POLES MADE OF 2" X 2" LUMBER AT ALL RISER LOCATIONS. WYE POLES SHALL EXTEND 3' ABOVE THE GROUND.

THE CONTRACTOR SHALL PLACE CUTOFF TRENCH DAMS OF NATIVE CLAY OR IMPERVIOUS SOILS ACROSS AND ALONG THE TRENCH AT 150-FOOT INTERVALS TO RETARD AND RESIST THE MOVEMENT OF GROUNDWATER THROUGH THE TRENCH GRANULAR BEDDING OR BACKFILL MATERIAL AS NOTED IN CMSC ITEM 901.11.

FIELD LEAKAGE TEST SHALL BE PERFORMED ON ALL SECTIONS OF SANITARY SEWER PROJECTS (INCLUDING SERVICE LINES CONSTRUCTED UNDER THE SEWER PLAN) IN ACCORDANCE WITH 901.20 OF THE CITY OF COLUMBUS MATERIAL SPECIFICATIONS. ALL MANHOLES WILL ALSO BE TESTED IN ACCORDANCE WITH CURRENT 901.20 SPECIFICATIONS.

INFILTRATION/EXFILTRATION LIMITS SHALL NOT EXCEED 100 GALLONS PER INCH OF TRIBUTARY PIPE DIAMETER PER 24 HOURS PER MILE OF PIPE LENGTH (OR COMPUTED EQUIVALENT FOR SHORTER PERIODS OF TIME). ALL SANITARY SEWER SHALL BE TESTED PER THE SPECIFICATIONS.

ALL P.V.C. SEWER LINES SHALL BE DEFLECTION TESTED AFTER INSTALLATION IN CONFORMANCE WITH THE REQUIREMENTS OF ITEM 901.21 OF THE CITY OF COLUMBUS, CONSTRUCTION AND MATERIAL SPECIFICATIONS, CURRENT VERSION.

ACCEPTANCE TESTING, (DEFLECTION AND LEAKAGE) OF ALL SANITARY SEWERS SHALL REQUIRE A 30-DAY WAITING PERIOD FROM THE DATE OF FINAL BACKFILLING. THIS SHALL INCLUDE ALL LATERALS INSTALLED AS PART OF MAINLINE CONSTRUCTION. TESTING SHALL CONFORM TO THE REQUIREMENTS OF ITEM 901 OF THE CITY OF COLUMBUS, CONSTRUCTION AND MATERIAL SPECIFICATIONS CURRENT VERSION.

ROOF DRAINS, FOUNDATION DRAINS, AND OTHER CLEAN WATER CONNECTIONS TO THE SANITARY SEWER SYSTEM ARE PROHIBITED ON THIS PROJECT.

ALL EXISTING INVERTS ALONG WITH THE PROPOSED TOP OF CASTING ELEVATIONS SHALL BE VERIFIED BY THE CONTRACTOR PRIOR TO CONSTRUCTION OF THE SEWER.

THE CONTRACTOR SHALL MAKE ALLOWANCE IN HIS BID FOR POSSIBLE ADJUSTMENT ON LEVEL OF MANHOLE TOPS AND SHALL RECEIVE NO ADDITIONAL COMPENSATION BECAUSE OF ANY SUCH ADJUSTMENTS THAT ARE REQUIRED TO BE MADE.

ALL CONCRETE PIPE, STORM AND SANITARY SEWER STRUCTURES SHALL BE STAMPED OR HAVE SUCH IDENTIFICATION NOTING THAT SAID PIPE, STORM AND SANITARY STRUCTURES HAVE BEEN INSPECTED BY THE CITY OF COLUMBUS AND MEET THEIR SPECIFICATIONS. PIPE AND STRUCTURES WITHOUT PROPER IDENTIFICATION WILL NOT BE PERMITTED FOR INSTALLATION.

THE CONTRACTOR SHALL ENSURE THERE IS A SURVEYOR'S LEVEL AND ROD ON THE PROJECT FOR

USE IN PERFORMING GRADE CHECKS WHENEVER SEWER LINE STRUCTURES OR PIPE ARE BEING INSTALLED. THE CONTRACTOR SHALL MAKE THIS EQUIPMENT AVAILABLE FOR THE USE OF AND ASSIST THE CITY INSPECTOR IN PERFORMING GRADE CHECKS WHEN REQUESTED BY THE INSPECTOR.

THE INSPECTOR WILL MAKE ALL REASONABLE ATTEMPTS TO CONFINE REQUESTS FOR ASSISTANCE IN PERFORMING GRADE CHECKS TO TIMES CONVENIENT TO THE CONTRACTOR.

THESE CHECKS WILL BE PERFORMED TO ENSURE THE FOLLOWING:

1. PROPER PLACEMENT OF EACH STRUCTURE.
2. PROPER INSTALLATION OF PIPE RUNS.
3. GRADE, AFTER AN OVERNIGHT OR LONGER SHUTDOWN.
4. GRADE, AT ANY OTHER TIME THE INSPECTOR HAS REASON TO QUESTION GRADE.

GRADE CHECKS PERFORMED BY THE CITY INSPECTOR IN NO WAY RELIEVE THE CONTRACTOR FOR THE ULTIMATE RESPONSIBILITY TO ENSURE CONSTRUCTION TO THE PLAN GRADE.

BACKFILL SHALL BE IN ACCORDANCE WITH THE SPECIFICATIONS SHOWN ON THE SANITARY SEWER PROFILES, REFERENCE SHEET NO. #.

EXISTING UTILITIES

THE IDENTITY AND LOCATION OF THE EXISTING UNDERGROUND UTILITY FACILITIES KNOWN TO BE LOCATED IN THE CONSTRUCTION AREA HAVE BEEN SHOWN ON THE PLANS AS ACCURATELY AS PROVIDED BY THE OWNER OF THE UNDERGROUND UTILITY. THE CITY OF COLUMBUS AND/OR ENGINEER ASSUMES NO RESPONSIBILITY TO THE ACCURACY OF THE LOCATIONS OR THE DEPTHS OF THE UNDERGROUND FACILITIES SHOWN ON THE PLANS.

INVESTIGATION, LOCATION, SUPPORT, PROTECTION AND RESTORATION OF ALL EXISTING UTILITIES AND APPURTENANCES SHALL BE THE RESPONSIBILITY OF THE CONTRACTOR. THIS WORK INCLUDES MAINTENANCE OF ADEQUATE DEPTH ON ALL EXISTING UTILITY FACILITIES. THE CONTRACTOR IS RESPONSIBLE TO IDENTIFY AND COORDINATE FIELD STAKEOUT OF ALL LOCATIONS OF POSSIBLE GRADE CONFLICTS WITH EXISTING UTILITIES PRIOR TO CONSTRUCTION. THE COST OF THIS WORK SHALL BE INCLUDED IN THE BID PRICE FOR THE SANITARY SEWER IMPROVEMENTS.

THE CONTRACTOR SHALL EXPOSE ALL UTILITIES OR STRUCTURES PRIOR TO CONSTRUCTION TO VERIFY THE VERTICAL AND HORIZONTAL EFFECT ON THE PROPOSED CONSTRUCTION.

THE CONTRACTOR SHALL BE RESPONSIBLE FOR COORDINATING THE RELOCATION AND/OR PROTECTION OF ANY UTILITIES AS REQUIRED BY THE PLAN WITH THE OWNER OF THE AFFECTED UTILITY.

PRIVATE UTILITY MANHOLES WITHIN THE LIMITS OF THE WORK SHALL BE ADJUSTED TO GRADE BY THE RESPECTIVE UTILITY.

THE CONTRACTOR SHALL GIVE NOTICE TO THE OHIO UTILITIES PROTECTION SERVICE (TELEPHONE 800-362-2764 TOLL-FREE) 48 HOURS PRIOR TO CONSTRUCTION AND TO THE OWNERS OF THE UNDERGROUND UTILITIES WHO ARE NOT MEMBERS OF A REGISTERED UNDERGROUND PROTECTION SERVICE IN ACCORDANCE WITH SECTION 153.64 OF THE REVISED CODE.

THE FLOW IN ALL SEWERS, DRAINS, FIELD TILES AND WATERCOURSES ENCOUNTERED SHALL BE MAINTAINED BY THE CONTRACTOR AT HIS EXPENSE, AND WHENEVER SUCH WATERCOURSES AND DRAINS ARE DISTURBED OR DESTROYED DURING THE PROSECUTION OF THE WORK, THEY SHALL BE RESTORED BY THE CONTRACTOR AT HIS OWN COST AND EXPENSE TO A CONDITION SATISFACTORY TO THE CONSTRUCTION MANAGER.

ALL DRAIN TILE AND STORM SEWERS DAMAGED, DISTURBED, OR REMOVED AS A RESULT OF THE CONTRACTOR'S OPERATIONS SHALL BE REPLACED WITH THE SAME QUALITY PIPE OR BETTER, MAINTAINING THE SAME GRADIENT AS EXISTING. THE DRAIN TILE AND/OR STORM SEWER SHALL BE CONNECTED TO THE CURB SUBDRAIN, STORM SEWER SYSTEM OR PROVIDED WITH AN OUTLET INTO THE ROADWAY DITCH AS APPLICABLE. REPLACED DRAIN TILE/STORM SEWER SHALL BE LAID ON COMPACTED BEDDING EQUAL IN DENSITY TO SURROUNDING STRATUM. COST OF THIS WORK TO BE INCLUDED IN THE PRICE BID FOR THE SANITARY SEWER IMPROVEMENTS.

DEWATERING

THE CONTRACTOR IS RESPONSIBLE TO PROVIDE ALL DEWATERING OPERATIONS AS REQUIRED TO ACCOMPLISH THE PROPOSED CONSTRUCTION OPERATIONS. REFERENCE THE SOILS REPORT FOR GROUNDWATER CONSIDERATIONS.

INSTALLATION OF ANY WELL, WELL POINT, PIT OR OTHER DEVICE USED FOR THE PURPOSE OF REMOVING GROUNDWATER FROM AN AQUIFER SHALL BE IN ACCORDANCE WITH THE APPLICABLE REQUIREMENTS OF THE OHIO DEPARTMENT OF NATURAL RESOURCES.

THE CONTRACTOR SHALL BE RESPONSIBLE TO PLACE AND MAINTAIN THE NECESSARY SEDIMENT CONTROL MEASURES TO FILTER THE DEWATERING DISCHARGE. COST FOR THE ABOVE SHALL BE INCLUDED IN THE BID PRICE FOR THE SANITARY SEWER IMPROVEMENTS.

SOILS

A SUBSURFACE INVESTIGATIONS REPORT HAS BEEN PREPARED BY GEOTECHNICAL CONSULTANTS, INC. FOR THE DEVELOPMENT SITE. THE RECOMMENDATIONS SERVE AS THE PROJECT GUIDELINES AND ARE NOT INTENDED TO LIMIT THE DESIGN OR THE WORK PRODUCT. IT SHALL BE THE CONTRACTOR'S RESPONSIBILITY TO OBTAIN A COPY OF THE SOILS REPORT.

EROSION AND SEDIMENT CONTROL MEASURES ARE REQUIRED AS PART OF THIS PROJECT. EROSION AND SEDIMENT CONTROL MEASURES SPECIFIC TO THIS SITE MAY BE FOUND ON DRAWING NUMBER CC-STORM.

IT IS THE RESPONSIBILITY OF THE SITE OWNER TO NOTIFY THE CITY OF COLUMBUS 2 WORKING DAYS PRIOR TO COMMENCEMENT OF THE INITIAL SITE LAND DISTURBANCE ON ANY SITE OF ONE OR MORE ACRES. THIS INCLUDES SITE CLEARING, GRUBBING, AND EARTH MOVING. PRIMARY EROSION AND SEDIMENT CONTROL PRACTICES ARE MANDATED BY REGULATION TO BE IN PLACE FROM THE BEGINNING OF THE CONSTRUCTION ACTIVITY. PLEASE CONTACT THE STORMWATER MANAGEMENT OFFICE @ (614) 645-6700 OR FAX @ (614) 645-1840. DETAILS OF THIS REQUIREMENT MAY BE FOUND IN THE EROSION AND SEDIMENT CONTROL REGULATION (ADOPTED JUNE 1, 1994). FAILURE TO COMPLY MAY RESULT IN ENFORCEMENT ACTION AS DETAILED IN THE CITY OF COLUMBUS CODES SECTION 1145.80.

LAND-DISTURBING ACTIVITIES MUST COMPLY WITH ALL PROVISIONS OF THE DIVISION OF SEWERAGE AND DRAINAGE EROSION AND SEDIMENT CONTROL REGULATION. ALL LAND-DISTURBING ACTIVITIES SHALL BE SUBJECT TO INSPECTION AND SITE INVESTIGATION BY THE CITY OF COLUMBUS AND/OR THE OHIO EPA. FAILURE TO COMPLY WITH THESE REGULATIONS IS SUBJECT TO LEGAL ENFORCEMENT ACTION.



SANITARY SEWER NOTE:
CONNECTION TO SANITARY SEWER CANNOT BE MADE WITHOUT OBTAINING A PERMIT FROM THE SEWER PERMIT OFFICE AT 111 N. FRONT STREET, 1ST FLOOR, 614-645-7490.

SANITARY SEWER CAPOFF NOTE:
SEWER CAPOFF PERMIT IS REQUIRED PRIOR TO ISSUANCE OF DEMOLITION PERMIT. OBTAIN CAPOFF A PERMIT FROM THE SEWER PERMIT OFFICE AT 111 N. FRONT STREET, 1ST FLOOR, 614-645-7490.

CITY OF COLUMBUS, OHIO SANITARY SEWER PLAN FOR: PENZONE LIVE-WORK 2024

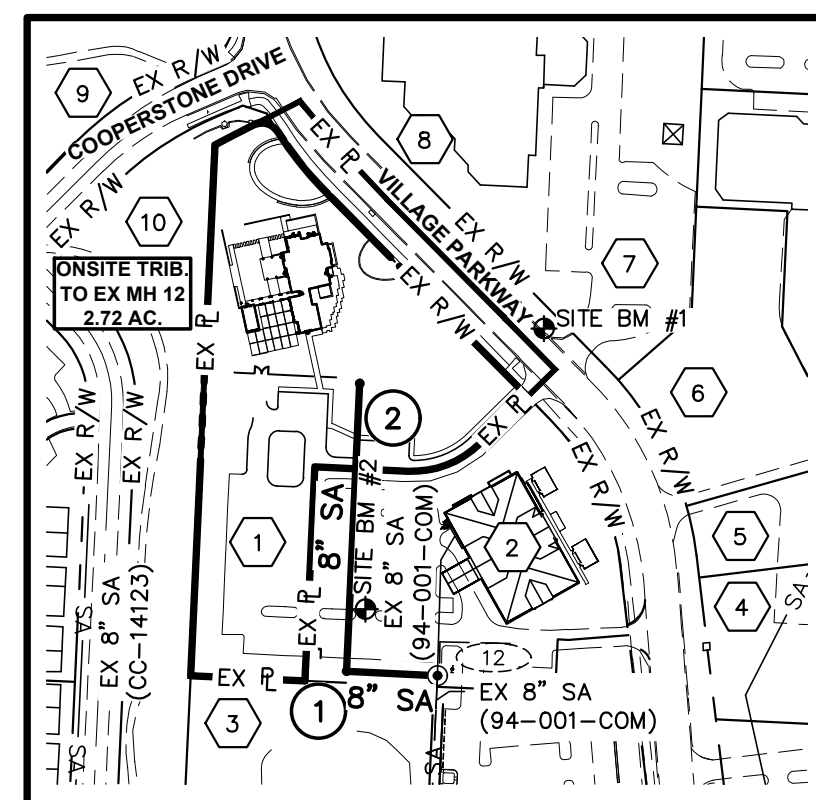

INDEX/TRIBUTARY AREA MAP
SCALE: 1" = 200'

GRAPHIC SCALE

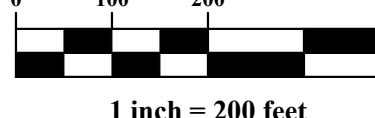

1 inch = 200 feet

INDEX OF DRAWINGS	
SHEET NUMBER	SHEET TITLE
1	TITLE
2	PLAN AND PROFILE

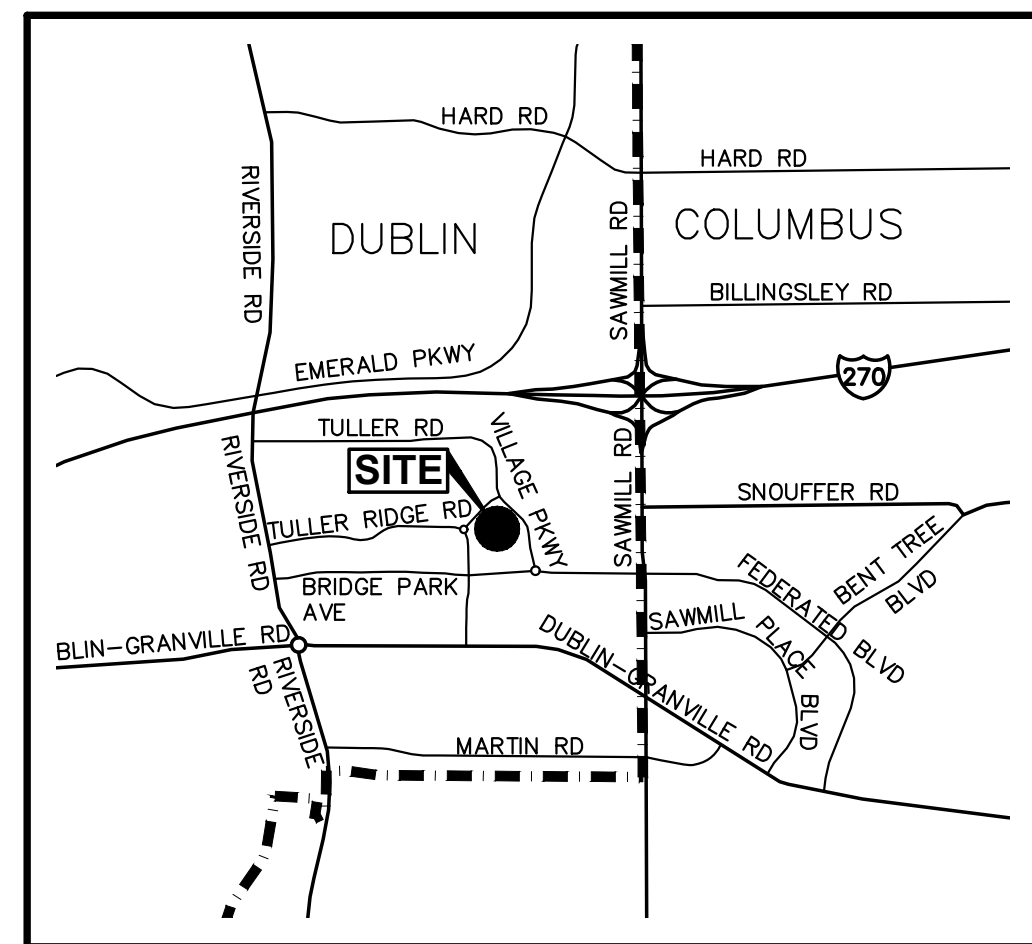

SITE LOCATION MAP
NOT TO SCALE

ENGINEER - APPLICANT
ADVANCED CIVIL DESIGN, INC.
781 SCIENCE BOULEVARD, SUITE 100
GAHANNA, OH 43230
PHONE (614) 428-7750
FAX (614) 428-7755
CONTACT: RYAN FOWLER, P.E.
EMAIL: RFOLEWER@ADVANCEDCIVILDESIGN.COM

APPLICANT - ARCHITECT
MEYERS AND ASSOCIATES
232 NORTH THIRD STREET, SUITE 300
COLUMBUS, OHIO 43215
PHONE: 614-221-9433
CONTACT: CHRISTOPHER MEYERS
EMAIL: CMEYERS@MEYERSARCHITECTS.COM

STANDARD CONSTRUCTION DRAWINGS
THE STANDARD CONSTRUCTION DRAWINGS LISTED ON THESE PLANS SHALL BE A PART THEREOF.

CITY OF COLUMBUS **CITY OF DUBLIN**

AA-S102	AA-S149	SA-01
AA-S106	AA-S150	SA-02
AA-S107	AA-S151	SA-03
AA-S111	AA-S160	
AA-S117	AA-S161	
AA-S119		

BENCHMARKS

BASED ON NAVD 1988 DATUM.

SOURCE - ELEVATIONS WERE ESTABLISHED USING 45 MINUTE STATIC OBSERVATIONS UTILIZING GLOBAL POSITIONING SYSTEM (GPS) PROCEDURES. THE GPS DATA WAS SUBMITTED TO THE NATIONAL GEODETIC SURVEY'S (NGS) ONLINE POSITIONING USER SERVICE RAPID-STATIC (OPUS-RS) SYSTEM FOR PROCESSING. THE SYSTEM USES THE CONTINUALLY OPERATING REFERENCE STATIONS (CORS) TO ESTABLISH THE GEODETIC LOCATIONS.

SITE BM 1 - TOP OF SOUTHWEST BOLT OF EXISTING FIRE HYDRANT, 1.161'± SOUTH OF TULLER ROAD R/W AND 30'± EAST OF CENTERLINE OF VILLAGE PARKWAY. SHOWN ON BASE MAP AS "SITE BM #1".

ELEVATION = 897.22' (NAVD 88 DATUM)
ELEVATION = 897.62' (NGVD 29 DATUM)

SITE BM 2 - TOP OF NORTHWEST CORNER OF EXISTING ST CATCH BASIN, 532'± NORTH OF BRIDGE PARK AVENUE PAVEMENT EDGE AND 310'± WEST OF CENTERLINE OF VILLAGE PARKWAY. SHOWN ON BASE MAP AS "SITE BM #2".

ELEVATION = 890.55' (NAVD 88 DATUM)
ELEVATION = 890.95' (NGVD 29 DATUM)

SITE BM 3 - TOP OF NORTH CORNER BOLT OF EXISTING FIRE HYDRANT, 1,723'± SOUTH OF TULLER ROAD R/W AND 25'± EAST OF CENTERLINE OF VILLAGE PARKWAY. SHOWN ON BASE MAP AS "SITE BM #3".

ELEVATION = 900.20' (NAVD 88 DATUM)
ELEVATION = 900.60' (NGVD 29 DATUM)

PRIVATE WATER SERVICE PLAN: WSP#XXXX

NOTE TO PERMIT CLERK, CONTRACTOR AND CONSTRUCTION INSPECTOR:

1. THE SERVICE FOR THE PROPOSED BUILDING AT TBD IS TO BE INSTALLED IN CONJUNCTION WITH THE MAINLINE SEWER.
2. ALL APPROPRIATE PERMIT AND SYSTEM CAPACITY FEES FOR THIS BUILDING MUST BE PAID WITH THE STANDBY INSPECTION FEES PRIOR TO INSTALLATION.
3. NO SERVICES MAY BE CONNECTED TO ANY BUILDINGS UNTIL THE MAINLINE AND SERVICE LINE HAVE BEEN INSPECTED, TESTED AND APPROVED FOR USE.
4. IN THE EVENT THE BUILDING IS CONNECTED TO THE SERVICE BEFORE THE MAINLINE IS APPROVED FOR USE, THE DEVELOPER SHALL BE RESPONSIBLE FOR ALL COSTS TO DISCONNECT THE SERVICE AND HAVE ALL AFFECTED LINES THOROUGHLY CLEANED AND DISINFECTED BEFORE ANY FURTHER INSPECTION OR TESTING IS CONDUCTED FOR DIVISION OF DESIGN AND CONSTRUCTION APPROVAL OF THE PROJECT.
5. ALL BUILDING SIGN-OFF CARDS WILL BE SIGNED IN THE PERMIT OFFICE AFTER THE MAINLINE SEWER HAS BEEN TESTED AND APPROVED FOR USE.

SANITARY SEWER MEETS OR EXCEEDS CITY OF COLUMBUS DESIGN STANDARDS (INCLUDING PER CAPITA FLOW, PEAKING FACTOR, AND 1/1 ALLOWANCE) AND MATERIAL SPECIFICATIONS.

LEGEND

- 1 PROPOSED MANHOLE NUMBER
- 12 EXISTING MANHOLE
- TRIBUTARY BOUNDARY
- PROPOSED SANITARY SEWER
- EXISTING SANITARY SEWER
- PROPERTY BOUNDARY

HORIZONTAL CONTROL POINTS BASED ON NAD83 OHIO ZONE SOUTH (NSRS2011)			
No.	Description/Location	NORTHING	EASTING
CP#1	DESCRIPTION	X	X
CP#2	DESCRIPTION	X	X
CP#3	DESCRIPTION	X	X
CP#4	DESCRIPTION	X	X

EASEMENT REFERENCE			REVISIONS			PLAN PREPARED BY:		
CITY NO.	COUNTY RECORDER	GRANTOR	NO.	DESCRIPTION	APPROVAL/DATE	 781 Science Boulevard, Suite 100 Gahanna, Ohio 43230 PH 614.428.7750 FAX 614.428.7755		

APPROVED: FOR SANITARY SEWERS ONLY. SIGNATURES BELOW SIGNIFY ONLY CONCURRENCE WITH THE GENERAL PURPOSES AND GENERAL LOCATION OF THE PROJECT AND DOES NOT CONSTITUTE ASSURANCE TO OPERATE AS INTENDED. ALL TECHNICAL DETAILS REMAIN THE RESPONSIBILITY OF THE ENGINEER PREPARING THE PLANS. APPROVAL FOR SANITARY SEWERS ONLY. *APPROVAL ON THE PART OF THE CITY OF COLUMBUS IS GIVEN PURSUANT TO THE PROVISIONS OF THE SEWER SERVICE AGREEMENT WITH THE CITY OF DUBLIN, OHIO DATED APRIL 13, 1993 AND ALL SUBSEQUENT AMENDMENTS THEREOF.	
CITY ENGINEER, CITY OF DUBLIN, OHIO	DATE
DIRECTOR OF PLANNING, CITY OF DUBLIN, OHIO	DATE
ADMINISTRATOR, DIVISION OF SEWERAGE AND DRAINAGE, CITY OF COLUMBUS, OHIO	DATE
DIRECTOR OF PUBLIC UTILITIES, CITY OF COLUMBUS, OHIO	DATE

PROJECT TITLE:			
SANITARY SEWER PLAN FOR PENZONE LIVE-WORK TBD			
DIVISION USE ONLY		OWNER	
CONTRACTOR		INSPECTOR	
AGREEMENT	COMPLETED	SCALE: AS NOTED	
RPD	CKD	CID	CON.DR.
INDEX DETAIL	RECORD FILE	SHEET 1 / 2	

CITY OF COLUMBUS, OHIO DEPARTMENT OF PUBLIC UTILITIES DIVISION OF SEWERAGE AND DRAINAGE	
DIVISION USE ONLY	
CONTRACT DRAWING NO. CC-XXXXX	RECORD PLAN NO.

PM 633

