

NOTE:
IRON PIN SET ARE 5/8-INCH REBAR - 30 INCHES IN LENGTH WITH ORANGE PLASTIC CAP BEARING "DGL / MAS 8232"

LEGEND

- R/W RIGHT-OF-WAY
- P.O.B. POINT OF BEGINNING
- P.O.C. POINT OF COMMENCEMENT
- IRON PIN SET
- MAG NAIL SET

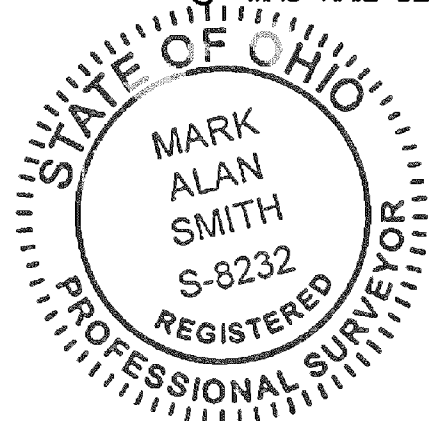

HIGHWAY EASEMENT
PERPETUAL EASEMENT FOR HIGHWAY PURPOSES WITHOUT LIMITATIONS OF EXISTING ACCESS RIGHTS IN THE NAME AND FOR THE USE OF THE CITY OF DUBLIN, OHIO, LOCATED IN FRANKLIN COUNTY, OHIO

BASIS OF BEARINGS:
THE BEARINGS SHOWN HEREON ARE BASED ON OHIO STATE PLANE COORDINATE SYSTEM, SOUTH ZONE (LAMBERT - 2011 ADJUSTMENT) WITH BEARING OF SOUTH 81°49'44" WEST DETERMINED FOR THE NORTH RIGHT OF WAY LINE OF BRIDGE STREET.

CERTIFICATION:
I HEREBY CERTIFY THIS EXHIBIT AS DELINEATED UPON WAS PREPARED FROM IN PART BY AN ON THE GROUND SURVEY AND RECORD INFORMATION AS OBTAINED AND THAT IT AND THE INFORMATION, COURSES AND DISTANCES AS SHOWN ARE CORRECT TO THE BEST OF MY KNOWLEDGE.

[Signature]
MARK ALAN SMITH, P.S.
OHIO PROFESSIONAL SURVEYOR NO. 8232

8/03/2023
DATE

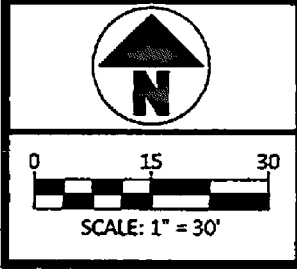

DGL
DGL CONSULTING ENGINEERS, LLC
5940 VENTURE DRIVE, SUITE D
DUBLIN, OHIO 43017
PHONE: 614.356.7150
www.dgl-ttd.com

EXHIBIT B
PART OF VIRGINIA MILITARY SURVEY 2512
CITY OF DUBLIN LOTS 110, 111 AND 112
CITY OF DUBLIN,
FRANKLIN COUNTY, OHIO
HIGHWAY EASEMENT

FILE:	23005-02-EXHBT-GE.dwg
JOB NO.:	23005-02
DRAWN BY:	MAS
ISSUED:	07/27/2023
1/1	