

# Belvedere Park Playground Renovation - Dublin, Ohio

Belvedere Park is in design for a playground renovation. The design includes all new play equipment and surfacing for children ages 2-12. The new play area will include a play structure with shade canopies, bridges, multi-use swings, slides and a unique swing called the Tri-Runner.

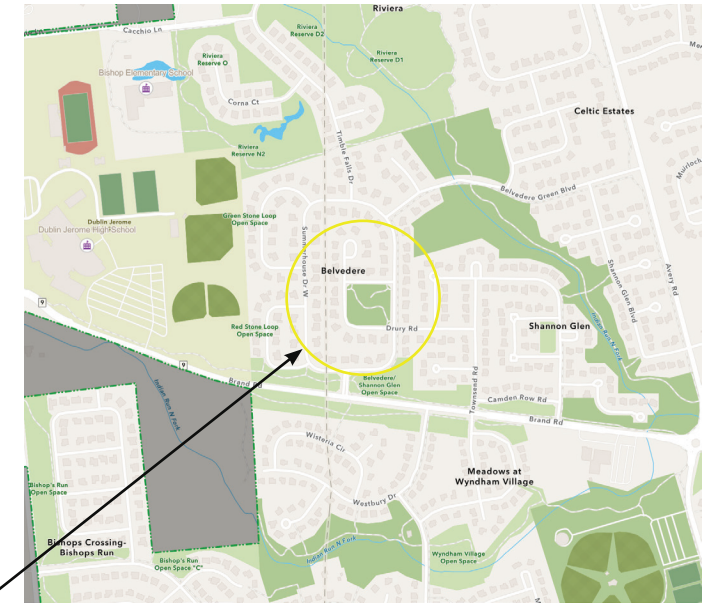

Project Site

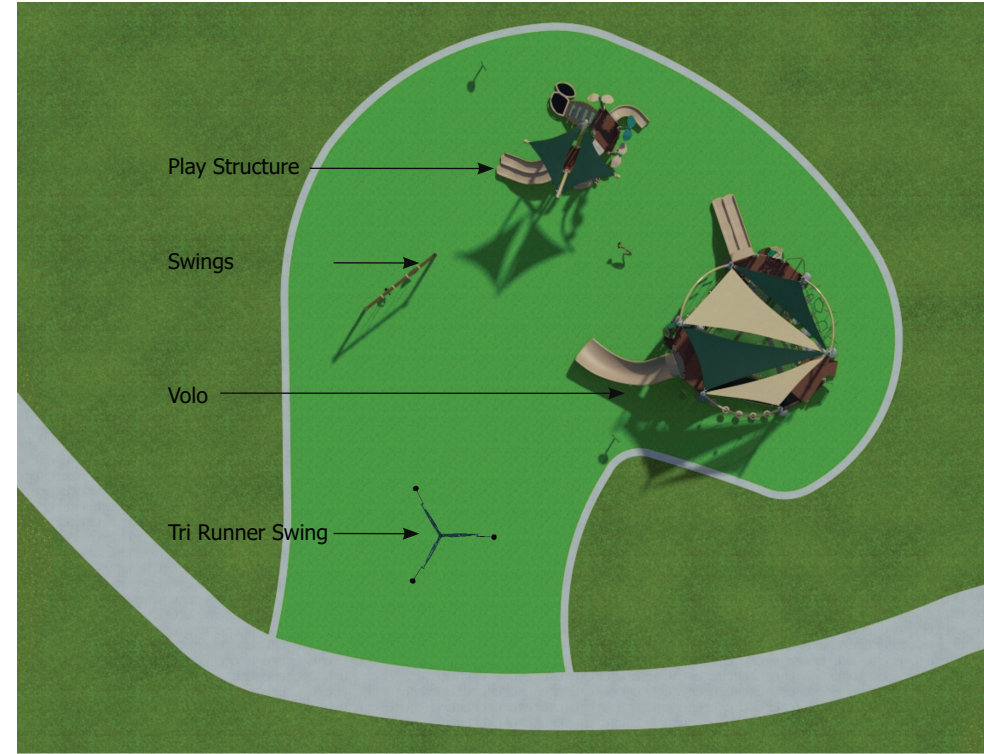

**Volo**  
Volo is a play-packed structure with twenty activities for everyone and it's concentrated on a compact footprint and with integrated shade. This structure invites kids to explore and create their own style of play with multiple layers of fun.



**Custom Play**  
This custom set for ages 2-5 includes 2 different slides and multiple climbers to encourage cognitive development and build lower-body strength.



**Swings**  
A traditional belt swing and toddler swing.



**Tri Runner Swing**  
The Tri Runner is a new way for children and adults to enjoy the sensation of flight on the playground. Three comfortable seats encourage social, cooperative spinning play. As users spin around, the panels disperse fun shadows on the ground below.

## Color Palette

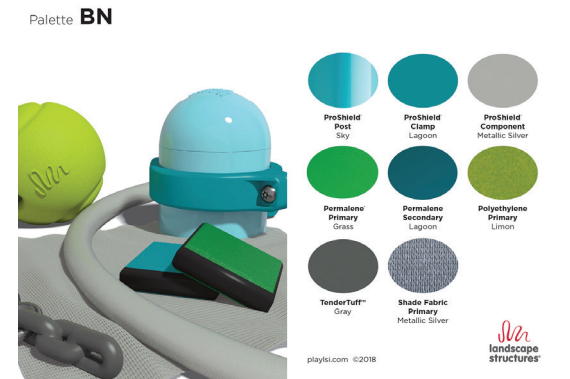

\* color shown may not reflect color used