

No.	SUITE	TENANT	ADDRESS	SQ. FT.
A	100	KROGER	299 WEST BRIDGE STREET	53,671
B	200	CVS / PHARMACY	305 " " "	10,069
C	500	PNC BANK	221 " " "	3,651
D	400	McDONALD'S	337 " " "	3,698
H	1040	GOLDEN CHINA EXPRESS	253 " " "	1,600
I	1035	DUBLIN ELITE MARTIAL ARTS	251 " " "	1,611
I-1	1030	DUBLIN CREW	249 " " "	3,628
J	1020	LeFLAIR BOUTIQUE	241 " " "	2,262
K	1010	JASON'S DELI	225 " " "	4,987
L	2010	ELEGANT BRIDE	313 " " "	2,500
M	2020	SWAN CLEANERS	317 " " "	3,000
N	2030	THE FRAMING CENTER	321 " " "	1,500
O	2031	CARTRIDGE WORLD	323 " " "	1,500
P	2040	THE PINK DOOR	329 " " "	3,000
Q	2050		331 " " "	2,500
R	2060	TAN PRO	333 " " "	2,500
S	2070	H2O NAIL SPA	339 " " "	1,500
T	2080	ANTHONY THOMAS	341 " " "	1,500
U	2085	FIRST CHOICE HAIRCUTTERS	343 " " "	1,430
U	2090	SUBWAY	345 " " "	1,570
V	2100	MASSAGE ENVY	357 " " "	3,000
W	2110	EMERALD SMILES	365 " " "	2,600
X	2120	ROUSH HARDWARE	373 " " "	17,730



191 W. Nationwide Blvd., Suite 200
 Columbus, Ohio 43215-2568
 614.228.5331
 castoinfo.com

WEST BRIDGE STREET - U. S. RTE. 33 & S.R. 161

CERTIFIED ADDRESSES
Kristin Baker 5/1/12
ISSUED BY DATE
CITY OF DUBLIN-PUBLIC SERVICE

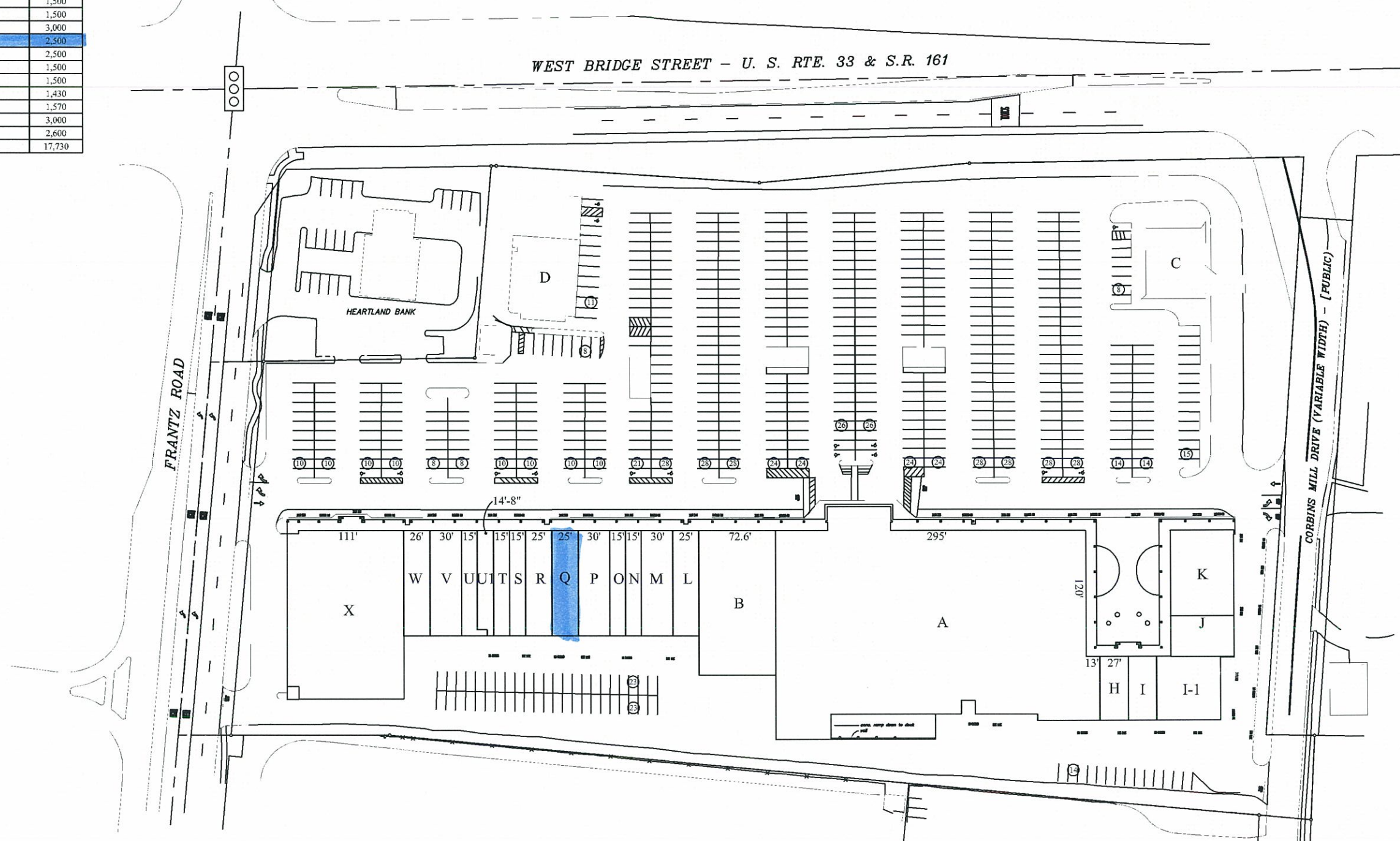

NORTH

SCALE: 1"=50'-0"

REVISIONS	
No.	DATE
39	10-4-10
40	11-16-10
41	5-2-11
42	7-29-11
43	8-5-11
44	12-7-11
45	1-17-12
46	2-7-12

DUBLIN PLAZA