

**Bridge Park East - Building C1, First Floor Addresses
Tenants A-C and Lobby Entrance**

Building C1 - First Floor	
Unit	Address
First Floor, Tenant A	6678 Riverside Drive
First Floor, Tenant B	6642 Riverside Drive
First Floor, Tenant C	6643 Longshore Street
Lobby	6725 Longshore Street

CERTIFIED ADDRESSES
C. Adam Stone 8-26-16
ISSUED BY DATE
CITY OF DUBLIN-PUBLIC SERVICE



BRIDGE PARK
DUBLIN, OH

GROSS LEASABLE AREA - 17,995 SF

182'-4 1/4"

*6725
Longshore Street*
Entry

Common Space	546 SF
Elev.	303 SF
Gas	125 SF
IT	42 SF
Patio A	124 SF
Patio B	1009 SF
Stairs	584 SF
Tenant A	489 SF
Tenant B	10510 SF
Tenant C	4671 SF
Water	1049 SF
Grand total	137 SF
	19568 SF

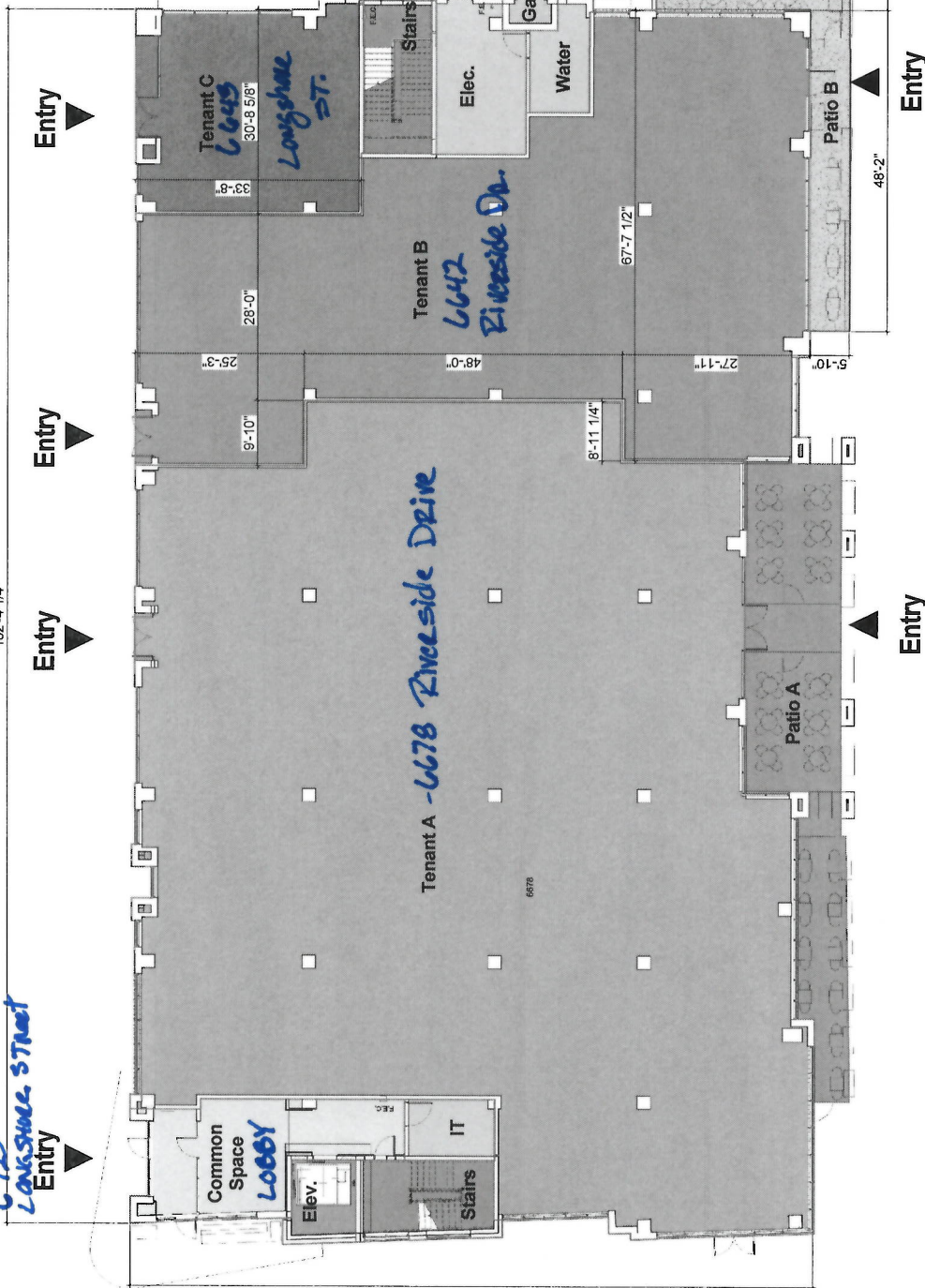

102'-4 7/8"

04/13/2016

KEY PLAN

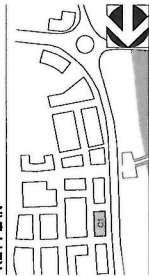

Building C1 - First Floor



MOODY•NOLAN
RESPONSIVE ARCHITECTURE

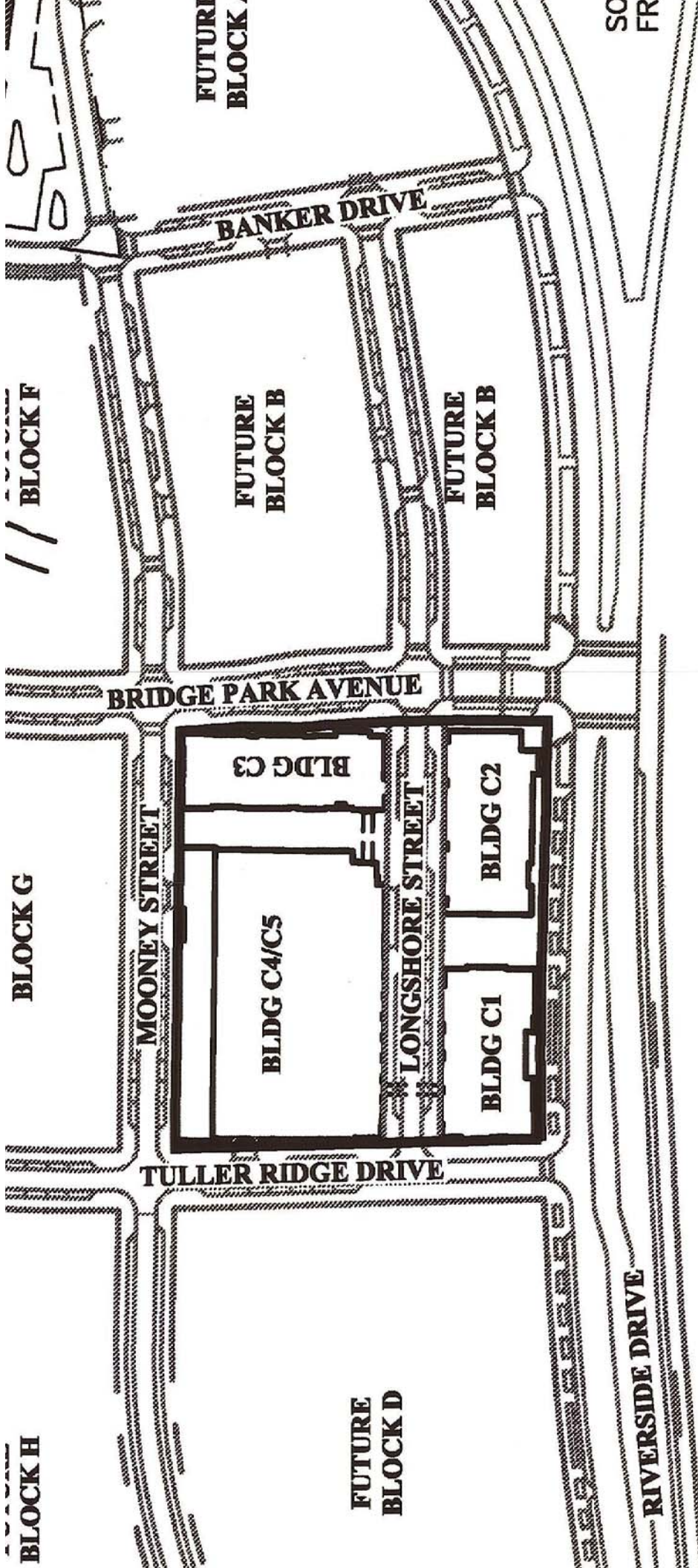

FUTURE
BLOCK

BANKER DRIVE

BLOCK F

FUTURE
BLOCK B

FUTURE
BLOCK B

BRIDGE PARK AVENUE

BLDG C3

BLOCK G

MOONEY STREET

BLDG C4/C5

LONGSHORE STREET

BLDG C2

BLDG C1

TULLER RIDGE DRIVE

FUTURE
BLOCK D

BLOCK H

RIVERSIDE DRIVE

SO
FR