

Bridge Park East - Building C3, Revised First Floor Addresses-

Building C3 - First Floor	
Unit	Address
Lobby	6636 Longshore Street
Tenant A	6632 Longshore Street
Tenant B	4548 Bridge Park Avenue
Tenant C	4546 Bridge Park Avenue
Tenant D	4544 Bridge Park Avenue
Tenant E	4540 Bridge Park Avenue

CERTIFIED ADDRESSES
C. [Signature] 1-4-17
ISSUED BY DATE
CITY OF DUBLIN-PUBLIC SERVICE

* This assignment is only to
Revise addresses for TENANT A
and TENANT E.

BRIDGE PARK
DUBLIN, OH

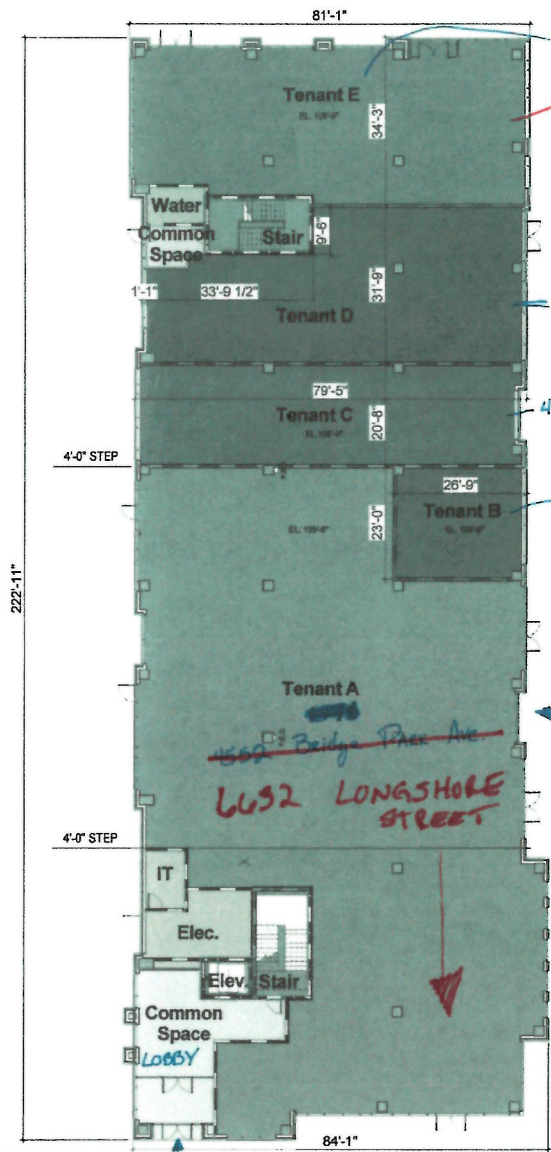

Common Space	772	SF
Elec.	303	SF
Elev.	92	SF
IT	112	SF
Stair	454	SF
Tenant A	8629	USF
Tenant B	610	USF
Tenant C	1620	USF
Tenant D	2134	USF
Tenant E	2598	USF
Water	110	SF

GROSS LEASABLE AREA - 17,435 SF
RENTABLE AREA - 16,889 SF

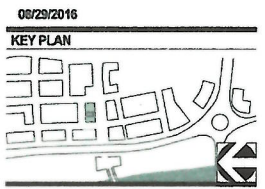

Building C3 - First Floor

BLOCK H

BLOCK G

BLOCK F

TULLER RIDGE DRIVE

MOONEY STREET

BRIDGE PARK AVENUE

LONGSHORE STREET

BANKER DRIVE

**FUTURE
BLOCK D**

BLDG C4/C5

BLDG C3

**FUTURE
BLOCK B**

**FUTURE
BLOCK A**

BLDG C1

BLDG C2

**FUTURE
BLOCK B**

RIVERSIDE DRIVE

**SO
FR**

