

**PLANIT**  
7792 Olentangy River Road  
Columbus, OH 43235  
planetstudios.com



Signature *Andrew J. English*

07/10/15  
Date

PERIMETER DRIVE ~ 80'

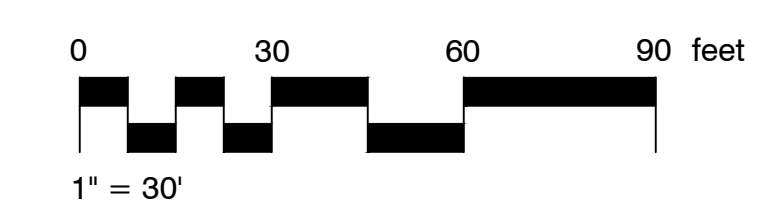
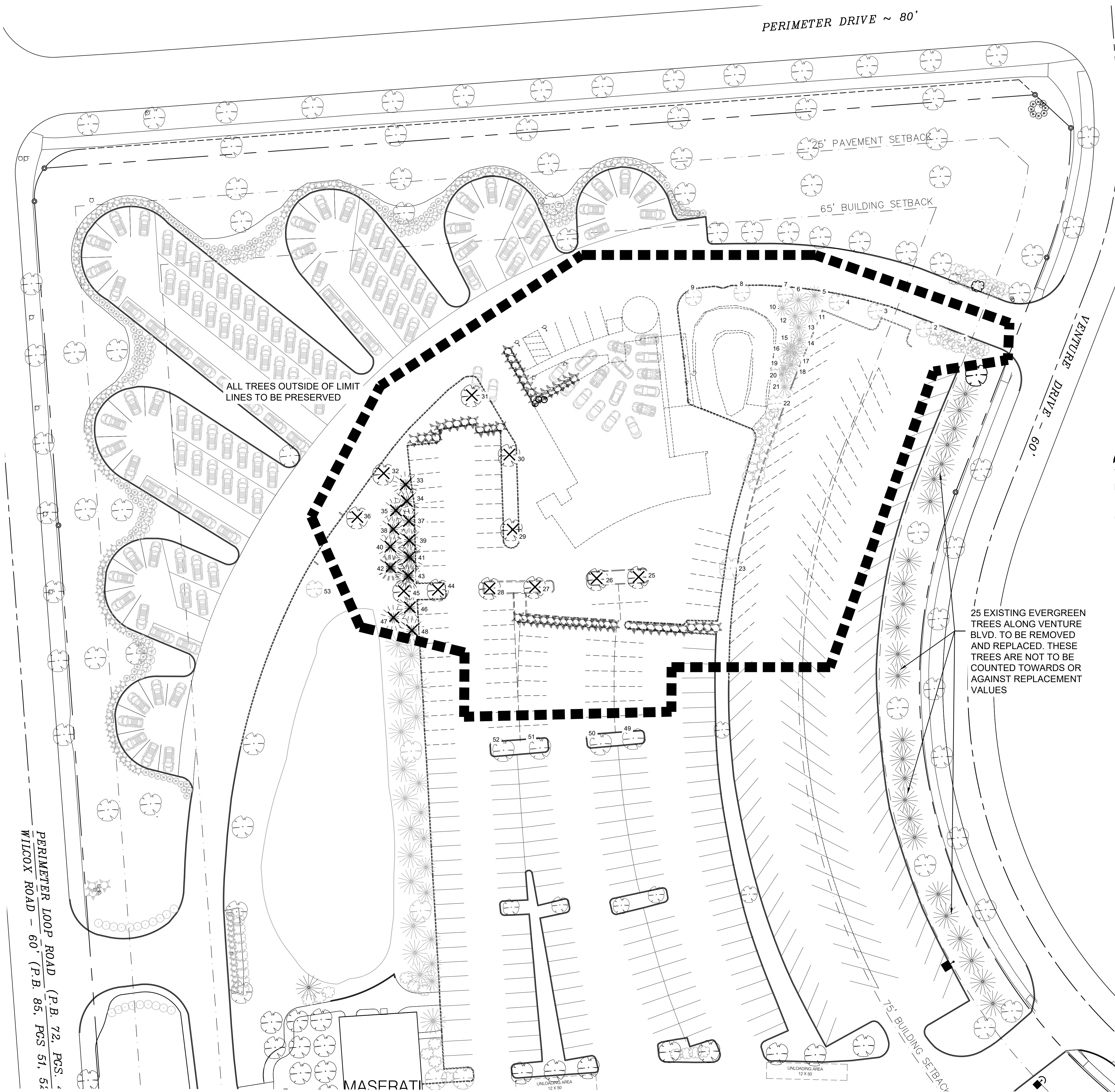

25 EXISTING EVERGREEN TREES ALONG VENTURE BLVD. TO BE REMOVED AND REPLACED. THESE TREES ARE NOT TO BE COUNTED TOWARDS OR AGAINST REPLACEMENT VALUES

Tree Inventory List  
Dustin Mag Porsche Forest

Tree #	Caliper	Type	Condition	Remarks	Replacement Value (Caliper)	Notes
1	10.0	OAK	GOOD	To be Preserved	0.0	
2	8.0	OAK	GOOD	To be Preserved	0.0	
3	8.0	OAK	GOOD	To be Preserved	0.0	
4	7.0	OAK	GOOD	To be Preserved	0.0	
5	7.0	SPRUCE	GOOD	To be Preserved	0.0	
6	4.0	SPRUCE	GOOD	To be Preserved	0.0	
7	5.5	OAK	GOOD	To be Preserved	0.0	
8	5.0	OAK	GOOD	To be Preserved	0.0	
9	4.0	OAK	GOOD	To be Preserved	0.0	
10	5.0	SPRUCE	GOOD	To be Preserved	0.0	
11	7.0	SPRUCE	GOOD	To be Preserved	0.0	
12	4.0	SPRUCE	GOOD	To be Preserved	0.0	
13	6.0	SPRUCE	GOOD	To be Preserved	0.0	
14	5.0	SPRUCE	GOOD	To be Preserved	0.0	
15			Not Present		0.0	
16			Not Present		0.0	
17			Not Present		0.0	
18			Not Present		0.0	
19			Not Present		0.0	
20	5.0	SPRUCE	DEAD	Tree to be removed	0.0	
21	4.0	SPRUCE	GOOD	To be Preserved	0.0	
22	8.0	OAK	GOOD	To be Preserved	0.0	
23	8.0	OAK	GOOD	To be Preserved	0.0	
24			Not Present		0.0	
25	4.0	OAK	GOOD	Tree to be removed	0.0	
26	5.0	OAK	GOOD	Tree to be removed	0.0	
27	8.0	OAK	GOOD	Tree to be removed	8.0	
28	8.0	OAK	GOOD	Tree to be removed	8.0	
29	8.0	OAK	GOOD	Tree to be removed	8.0	
30	8.0	OAK	GOOD	Tree to be removed	8.0	
31	8.0	OAK	GOOD	Tree to be removed	8.0	
32	8.0	OAK	GOOD	Tree to be removed	8.0	
33	10.0	SPRUCE	GOOD	Tree to be removed	10.0	
34	10.0	SPRUCE	GOOD	Tree to be removed	10.0	
35	10.0	SPRUCE	GOOD	Tree to be removed	10.0	
36	10.0	PLANE TREE	GOOD	Tree to be removed	10.0	
37	10.0	SPRUCE	GOOD	Tree to be removed	10.0	
38	8.0	SPRUCE	GOOD	Tree to be removed	8.0	
39	8.0	SPRUCE	GOOD	Tree to be removed	8.0	
40	8.0	SPRUCE	GOOD	Tree to be removed	8.0	
41	10.0	SPRUCE	GOOD	Tree to be removed	10.0	
42	10.0	SPRUCE	GOOD	Tree to be removed	10.0	
43	6.0	SPRUCE	GOOD	Tree to be removed	6.0	
44	8.0	OAK	GOOD	Tree to be removed	8.0	
45	16	CRABAPPLE	GOOD	Tree to be removed	16.0	
46	12.0	SPRUCE	GOOD	Tree to be removed	12.0	
47	12.0	SPRUCE	GOOD	Tree to be removed	12.0	
48	8.0	SPRUCE	GOOD	Tree to be removed	8.0	
49	5.5	KENTUCKY COFF TREE	GOOD	To be Preserved	0.0	
50	8.0	KENTUCKY COFF TREE	GOOD	To be Preserved	0.0	
51	5.5	KENTUCKY COFF TREE	GOOD	To be Preserved	0.0	
52	6.0	KENTUCKY COFF TREE	GOOD	To be Preserved	0.0	
53	12.0	PLANE TREE	GOOD	To be Preserved	0.0	

CALIPER INCHES TO BE REPLACE 201

**MAG PORSCHE  
NEW BUILDING**

5825 VENUTRE DRIVE, DUBLIN, OH 43017

DRAWING SET

<input type="checkbox"/>	preliminary
<input type="checkbox"/>	check
<input type="checkbox"/>	bid
<input checked="" type="checkbox"/>	08   07   2018 permit
<input type="checkbox"/>	construction

REVISIONS

△		
△		
△		
△		
△		
△		
△		
△		

SEAL

PROJECT NUMBER **A17-077**

SHEET TITLE **TREE REPLACEMENT PLAN**

SHEET NUMBER

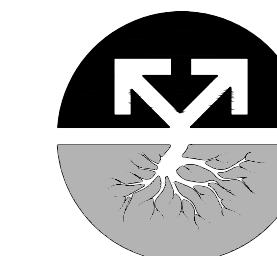

**PLANIT**  
7792 Olentangy River Road  
Columbus, OH 43235  
planitstudios.com

*Andrew J. English*  
Signature

07/10/15  
Date

**MAG PORSCHE  
NEW BUILDING**

5825 VENTURE DRIVE, DUBLIN, OH 43017

DRAWING SET

□	preliminary
□	check
□	bid
□	permit
□	construction

REVISIONS

△	
△	
△	
△	
△	
△	
△	

SEAL

PROJECT NUMBER **A17-077**

SHEET TITLE **LANDSCAPE PLAN**

SHEET NUMBER

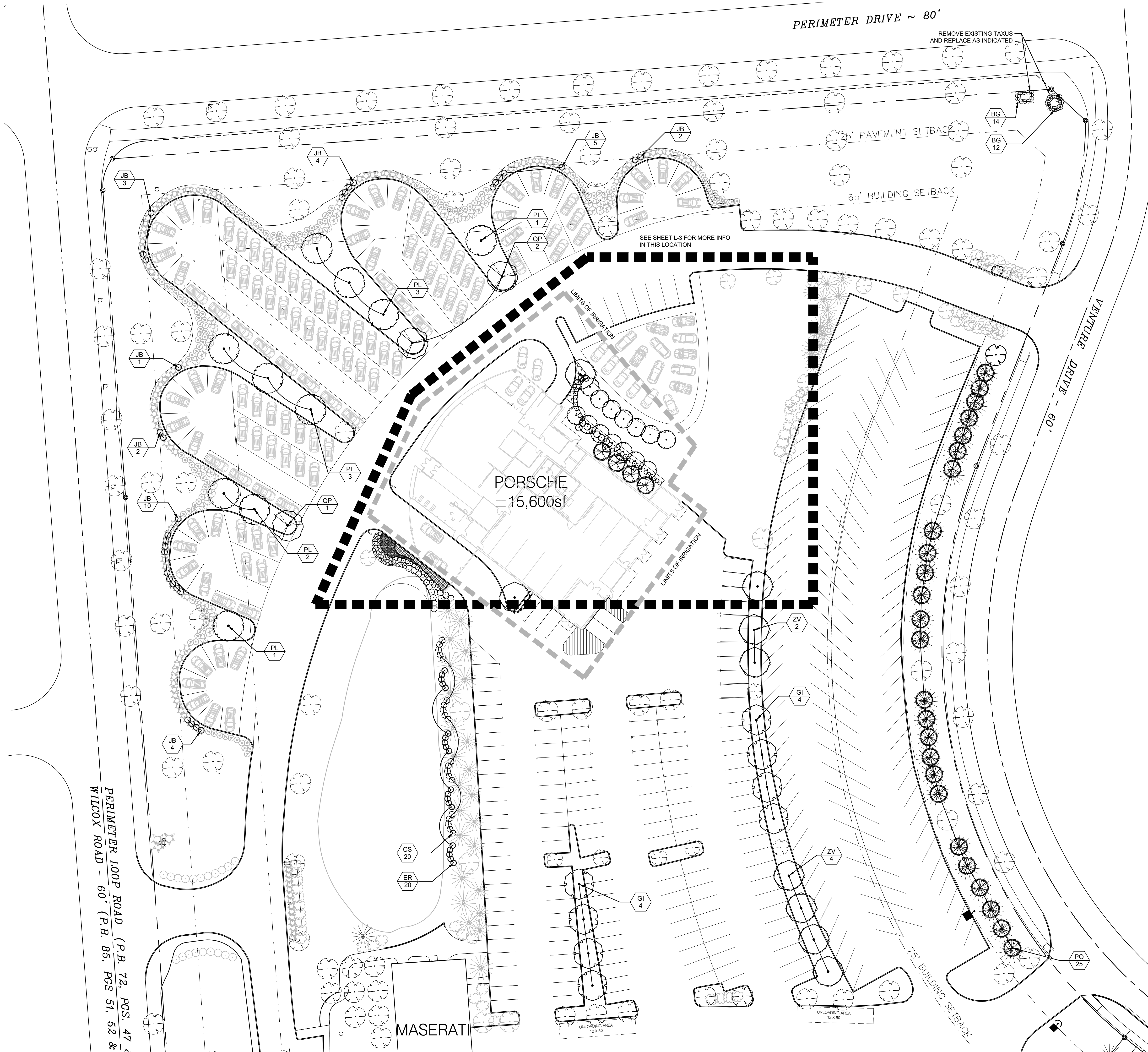



Signature

07/10/15  
Date

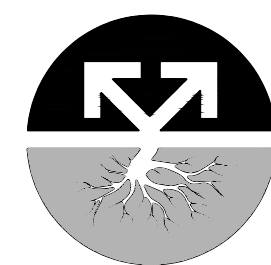

**PLANIT**  
7792 Orlentangy River Road  
Columbus, OH 43235  
plantstudios.com

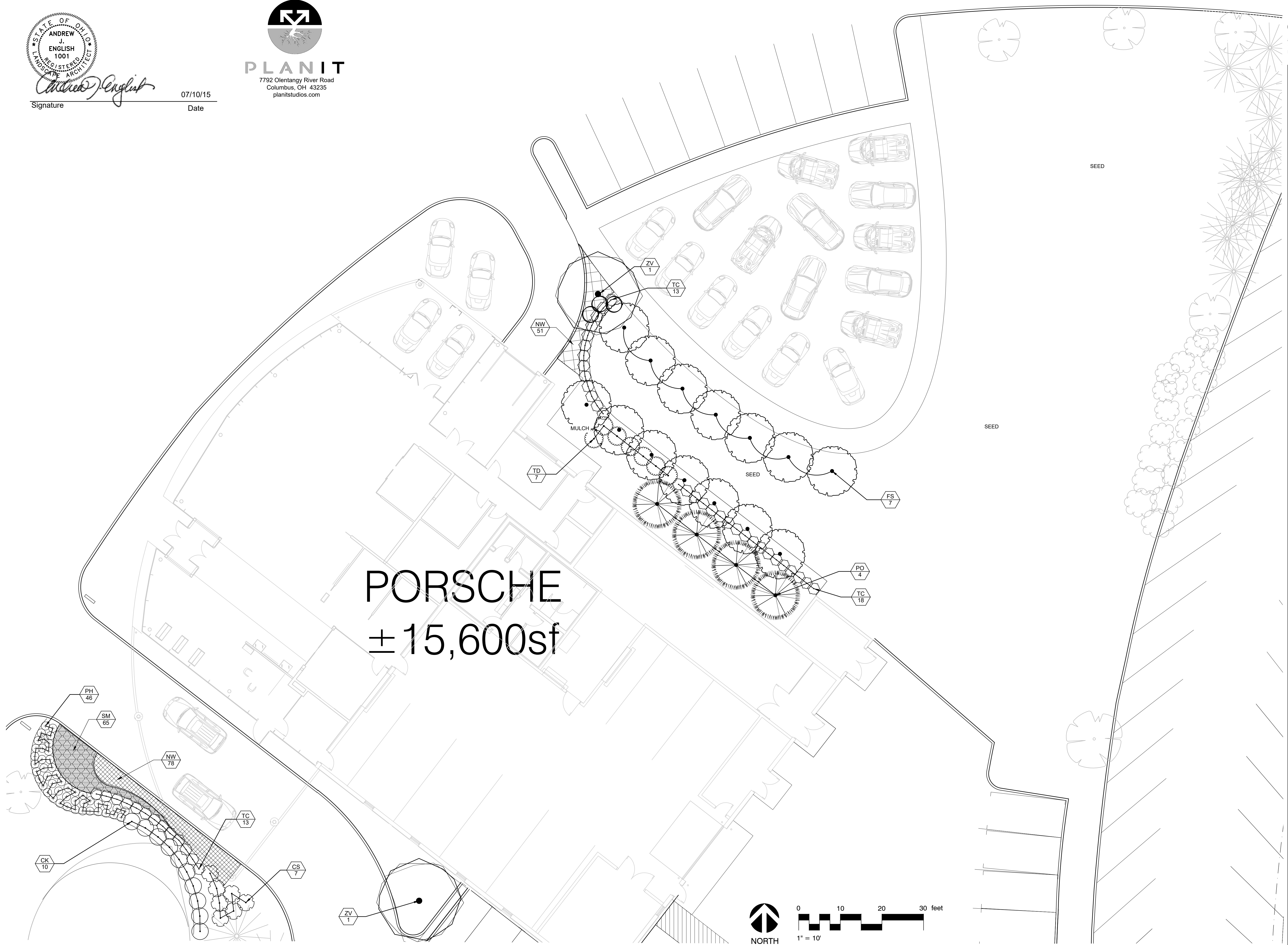

**PORSCHE**  
**± 15,600sf**

**MAG PORSCHE**  
**NEW BUILDING**

5825 VENUTRE DRIVE, DUBLIN, OH 43017

DRAWING SET

□	preliminary
□	check
□	bid
□	permit
□	construction

REVISIONS

△	
△	
△	
△	
△	
△	
△	

SEAL

PROJECT NUMBER **A17-077**

SHEET TITLE **LANDSCAPE PLAN**

SHEET NUMBER



Signature *Andrew J. English*

07/10/15  
Date

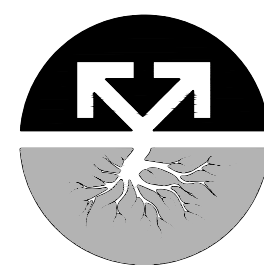

**PLANIT**  
7792 Orlentangy River Road  
Columbus, OH 43235  
plantstudios.com

LANDSCAPE TO BE ADDED  
AT A LATER DATE

**PLANT SCHEDULE 3a**

TREES	QTY	COMMON NAME / BOTANICAL NAME	CONT	CAL
FS	9	Tricolor Beech / <i>Fagus sylvatica Purpurea tricolor</i>	B & B	3"Cal
MP	5	Prairifire Crab Apple / <i>Malus x 'Prairifire'</i>	B & B	2.5"Cal
PL	3	London Plane Tree / <i>Platanus x acerifolia 'Liberty'</i>	B & B	3"Cal
ZV	3	Sawleaf Zelkova / <i>Zelkova serrata 'Village Green'</i>	B & B	3"Cal



**MAG PORSCHE  
NEW BUILDING**

5825 VENUTRE DRIVE, DUBLIN, OH 43017

DRAWING SET

- preliminary
- check
- bid
- 08 | 07 | 2018 permit
- construction

REVISIONS

- 
- 
- 
- 
- 
- 
- 
- 

SEAL

PROJECT NUMBER **A17-077**

SHEET TITLE **LANDSCAPE PLAN**

SHEET NUMBER

**L-3a**

**GENERAL PLANTING NOTES:**

1. SURVEY INFORMATION OBTAINED ELECTRONICALLY. PLAN-IT STUDIOS CANNOT ATTEST TO THE ACCURACY OR RELIABILITY OF LEGAL BOUNDARIES, EASEMENTS OR FIELD GATHERED DATA.
2. THE LOCATION OF THE EXISTING UNDERGROUND UTILITIES ARE SHOWN IN AN APPROXIMATE WAY ONLY AND HAVE NOT BEEN INDEPENDENTLY VERIFIED BY THE OWNER OR ITS REPRESENTATIVE. THE CONTRACTOR SHALL DETERMINE THE EXACT LOCATION OF ALL EXISTING UTILITIES PRIOR TO COMMENCING WORK AND AGREES TO BE FULLY RESPONSIBLE FOR ANY AND ALL DAMAGES WHICH MIGHT BE OCCASIONED BY THE CONTRACTOR'S FAILURE TO EXACTLY LOCATE AND PRESERVE ANY AND ALL UNDERGROUND UTILITIES.
3. ALL DIMENSIONS ARE TAKEN TO FACE OF CURB OR BUILDING WHERE APPLICABLE UNLESS OTHERWISE NOTED. USE DIMENSIONAL INFORMATION GIVEN. DO NOT SCALE DRAWINGS.
4. CONTRACTOR SHALL REFER QUESTIONS ON MATERIALS, FINISHES, LABOR, AND/OR PERFORMANCE STANDARDS NOT SPECIFIED HEREIN TO THE LANDSCAPE ARCHITECT.
5. ALL CHANGES TO DESIGN OR PLANT SUBSTITUTIONS ARE TO BE AUTHORIZED BY THE LANDSCAPE ARCHITECT.
6. CONSULT PLANT SCHEDULE FOR PLANT SIZES AND SPECIFICATIONS. CONTRACTOR IS RESPONSIBLE FOR ALL PLANTS DRAWN ON PLANS. PLANT LIST QUANTITIES ARE FOR CONVENIENCE ONLY.
7. ALL PLANTS TO CONFORM TO THE AMERICAN STANDARD FOR NURSERY STOCK (ANSI-Z60.1-2014) IN REGARDS TO SIZING, GROWING AND B&B SPECIFICATIONS.
8. ALL PROPOSED PLANTING BEDS TO BE TILLED TO A MINIMUM DEPTH OF 6".
9. ALL PLANTING BEDS TO BE FERTILIZED WITH 10-10-10 OR APPROVED EQUAL.
10. PLANTING HOLES TO BE DUG A MINIMUM OF TWICE THE WIDTH AND 6-8 INCHES DEEPER THAN THE SIZE OF THE ROOT BALL OF BOTH SHRUB AND TREE AND TO BE AMENDED WITH ORGANIC SOIL CONDITIONER.
11. IN AREAS WHERE BEDROCK OR HEAVILY COMPACTED ROCK FILL IS ENCOUNTERED, THE PLANTING HOLES ARE TO BE DUG TO A MINIMUM OF THREE TIMES THE WIDTH AND ONE FOOT DEEPER THAN THE SIZE OF THE ROOT BALL. NOTIFY LANDSCAPE ARCHITECT IF FIELD CONDITIONS WARRANT ADJUSTMENT OF PLANT LOCATIONS.
12. CONTRACTOR TO PROVIDE A FULL 1 YEAR GUARANTEE ON ALL PLANTS INSTALLED AND PROVIDE COMPLETE MAINTENANCE ON ALL WORK DONE BEGINNING ON THE DAY OF APPROVAL FROM OWNER'S REPRESENTATIVE AND CONTINUING FOR A THREE MONTH DURATION AT WHICH TIME OWNER'S REPRESENTATIVE WILL DECLARE JOB ACCEPTANCE.

13. ALL EXISTING PLANT MATERIAL SHOWN ON THIS PLAN IS TO BE PRESERVED UNLESS SPECIFICALLY NOTED OTHERWISE.
14. ALL SHRUBS AND GROUND COVER BEDS (EXISTING AND NEW), PLANTING BEDS, AND SHRUB MASSES SHALL HAVE A MINIMUM 3" DEEP SHREDDED HARDWOOD BARK MULCH. MULCH HEDGES IN A CONTINUOUS BED.
15. EXISTING GRASS TO BE REMOVED, IF PRESENT, AND TOPSOIL TO BE SPREAD SMOOTH AND HAND-RAKED TO REMOVE ALL ROCKS AND DEBRIS LARGER THAN 1 INCH IN DIAMETER PRIOR TO LAYING SOD OR SEEDING.
16. ALL AREAS DISTURBED BY CONSTRUCTION ARE TO BE RESTORED, FINE GRADED AND SEEDED. (SEE LANDSCAPE PLANS). SEEDING OR SODDING BY LANDSCAPE CONTRACTOR.
17. IF APPLICABLE LANDSCAPE CONTRACTOR TO COORDINATE WITH EXISTING OR PROPOSED IRRIGATION SYSTEM. IF PROPOSED IRRIGATION SYSTEM COORDINATE WITH IRRIGATION CONTRACTOR AND INSTALLATION OF SYSTEM.

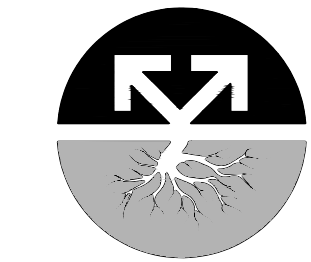

**PLANIT**  
7792 Olentangy River Road  
Columbus, OH 43235  
planetstudios.com

*Andrew J. English*  
Signature

07/10/15  
Date

**Site Data**

**Tree Replacement Requirement**  
42 trees removed, totaling 269 caliper inches removed  
Replaced with 204 caliper inches, (see planting plan)  
#4 8'-10' Evergreens counted as 3" caliper inches  
#64 Deciduous trees at 3" caliper each

**Property Perimeter Requirement**  
Existing Perimeter not affected.

**Vehicular Use Area Requirement**  
Existing Boundary not affected.

**Interior Landscaping for Vehicular Use Areas:**  
(See Plant Schedule for plants used to meet requirement)

**Landscape Area:**  
Required: 5 sf of landscape area per 100 sf of vehicular use area  
Proposed 26,826 sf of vehicular use area / 100 sf \* 5 sf = 1,342 sf  
Provided: 1,705 sf of interior landscaping with one tree per island

**Tree Planting:**  
Required: 1 Tree per 5,000 sf of building coverage. Trees to be 2.0" caliper in size.  
Proposed 23,100 sf of building coverage and VUA / 5000 sf = 5 Trees  
Provided: #5 2" Caliper Trees located on site.

**Additional Site Landscaping Requirement**  
Required: Business Community Use: Landscape areas equal to 2% of the building ground coverage area.  
Building sf = 23,100 sf \* 2% = 462 sf of landscape areas  
Provided: A minimum of 1,929 sf of Landscape Area has been implemented on the plan.

**Street Tree and Public Tree Requirement - Not Applicable**

**PLANT SCHEDULE**

TREES	QTY	COMMON NAME / BOTANICAL NAME	CONT	CAL	SIZE
FS	14	Tricolor Beech / Fagus sylvatica Purpurea tricolor	B & B	3"Cal	
GI	9	Skyline Thornless Honey Locust / Gleditsia triacanthos inermis 'Skycote' TM	B & B	3"Cal	
PL	10	London Plane Tree / Platanus x acerifolia 'Liberty'	B & B	3"Cal	
PO	29	Serbian Spruce / Picea omorika	B & B		8-10'
QP	3	Pin Oak / Quercus palustris	B & B	3"Cal	
ZV	8	Sawleaf Zelkova / Zelkova serrata 'Village Green'	B & B	3"Cal	
SHRUBS	QTY	COMMON NAME / BOTANICAL NAME	CONT		
BG	26	Boxwood / Buxus x 'Green Velvet'	2 gal		
CK	10	Feather Reed Grass / Calamagrostis x acutiflora 'Karl Foerster'	3 gal		
CS	27	Redbark Dogwood / Cornus alba 'Sibirica'	3 gal		
ER	20	Rudy Haag Burning Bush / Euonymus alatus 'Rudy Haag'	3 gal		
JB	31	Broadmoor Juniper / Juniperus sabina 'Broadmoor'	3 gal		
PH	46	Hamel Dwarf Fountain Grass / Pennisetum alopecuroides 'Hamel'	1 gal		
TC	44	Fire Chief Arborvitae / Thuja occidentalis 'Congabe'	3 gal		
TD	7	Dense Yew / Taxus x media 'Densiflora'	B & B		
GROUND COVERS	QTY	COMMON NAME / BOTANICAL NAME	CONT		SPACING
LB	79	Big Blue Lilyturf / Liriope muscari 'Big Blue'	1 gal		24" o.c.
NW	129	Walkers Low Catmint / Nepeta x faassenii 'Walkers Low'	4" pot		18" o.c.
SM	65	May Night Sage / Salvia nemorosa 'May Night'	4" pot		18" o.c.

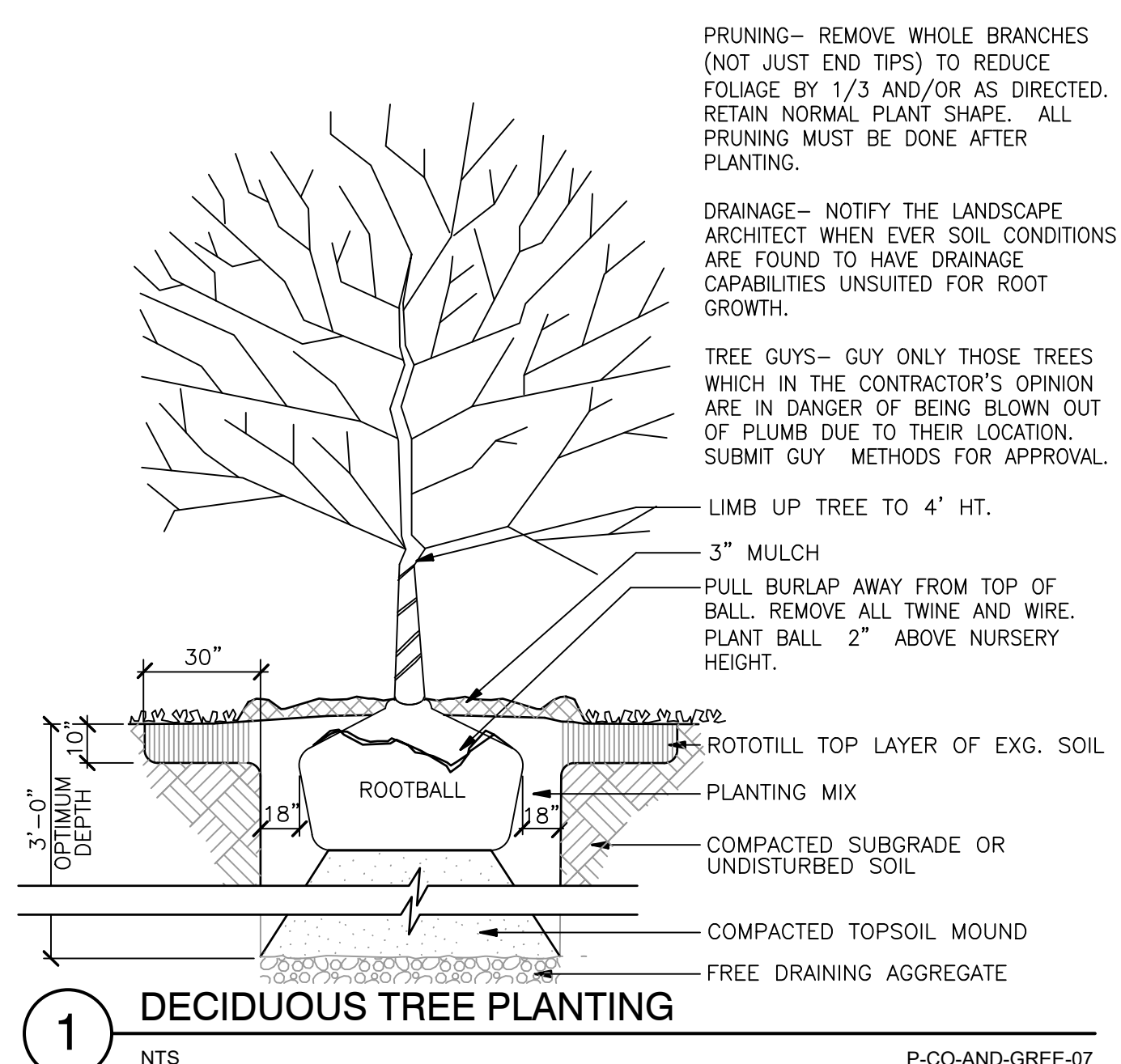

**1 DECIDUOUS TREE PLANTING**  
NTS P-CO-AND-GREE-07

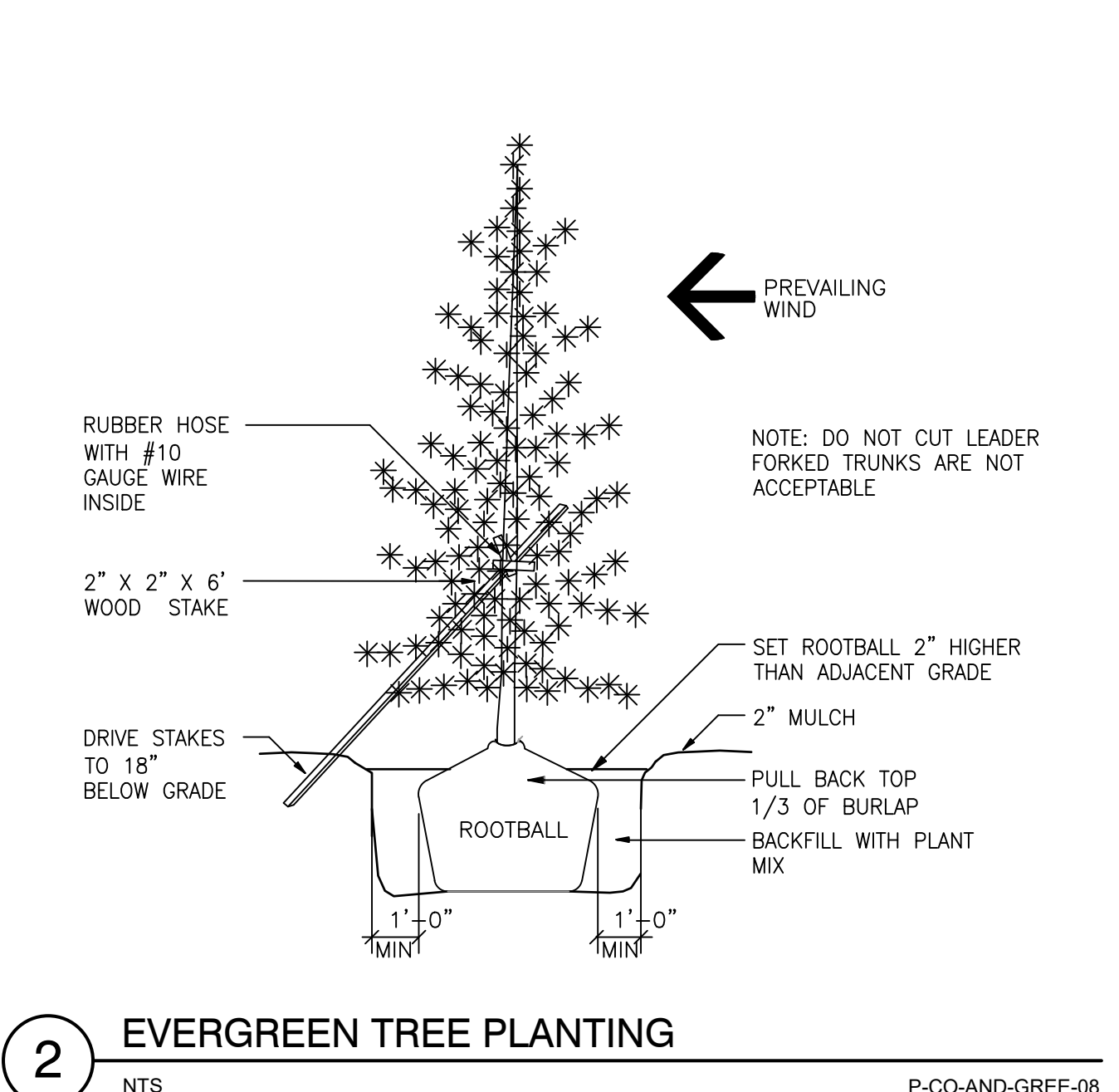

**2 EVERGREEN TREE PLANTING**  
NTS P-CO-AND-GREE-08

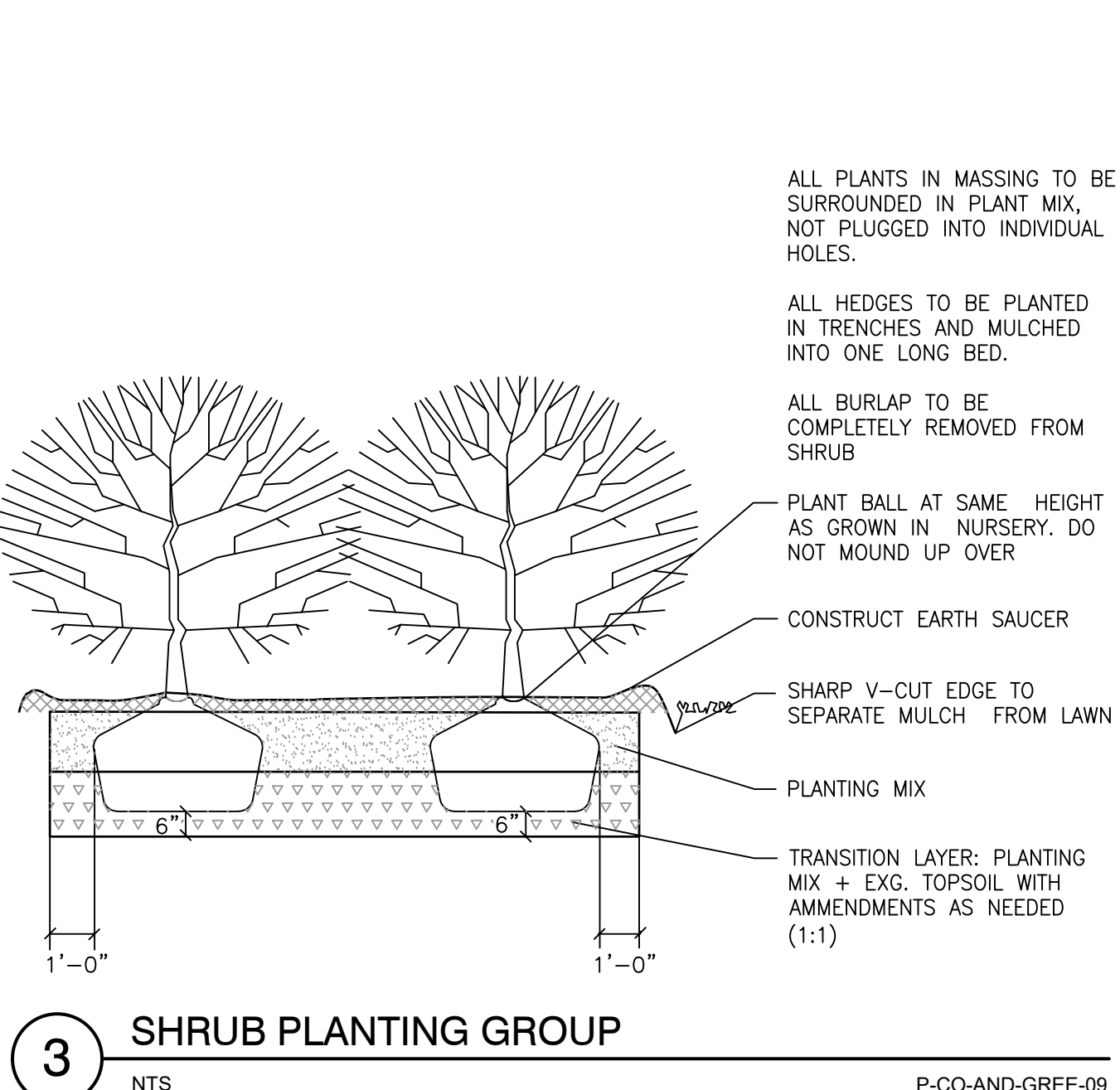

**3 SHRUB PLANTING GROUP**  
NTS P-CO-AND-GREE-09

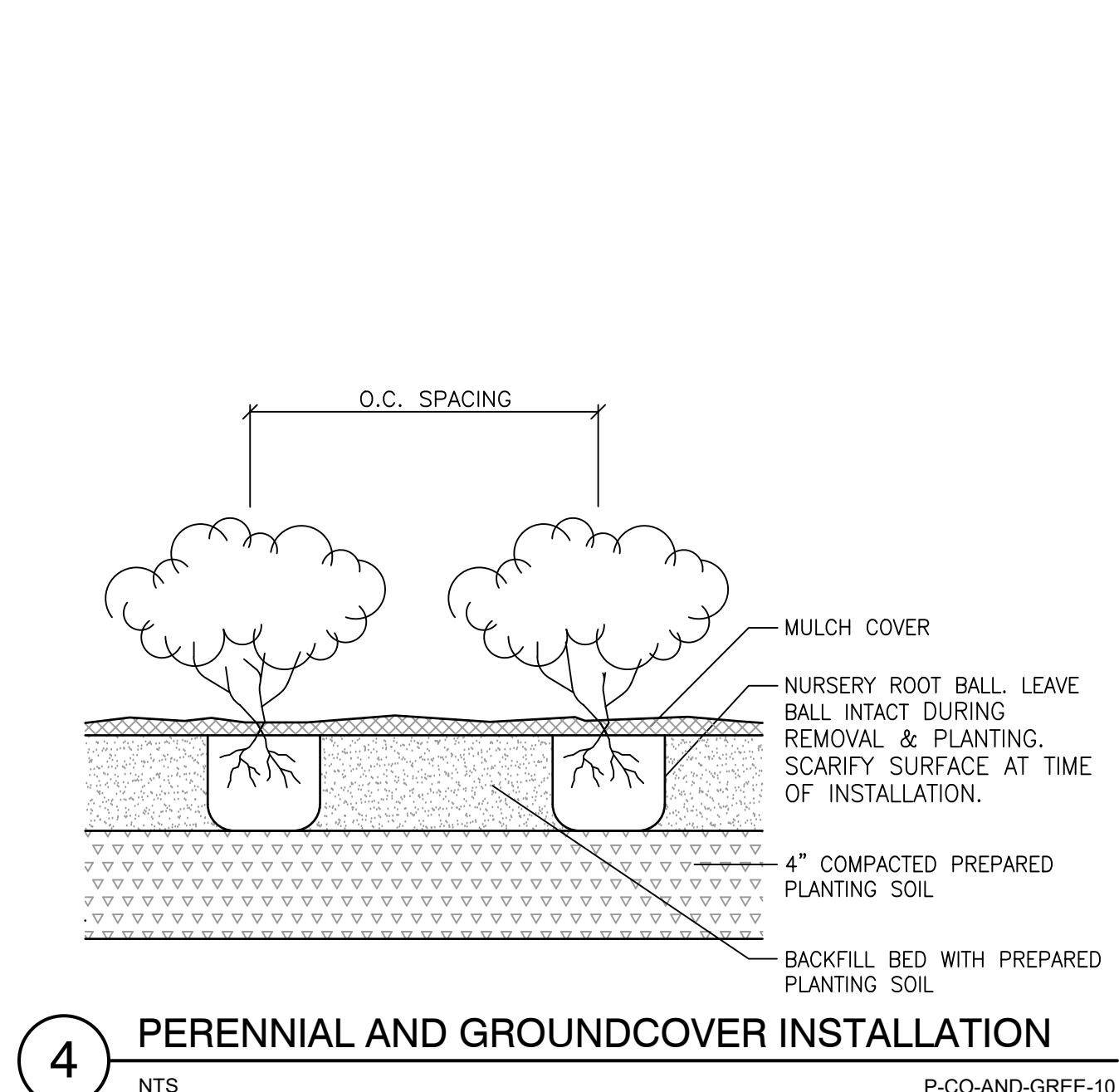

**4 PERENNIAL AND GROUNDCOVER INSTALLATION**  
NTS P-CO-AND-GREE-10

**MAG PORSCHE**  
**NEW BUILDING**  
5825 VENUTRE DRIVE, DUBLIN, OH 43017

**DRAWING SET**

<input type="checkbox"/>	preliminary
<input type="checkbox"/>	check
<input type="checkbox"/>	bid
<input type="checkbox"/>	08   07   2018 permit
<input type="checkbox"/>	construction

**REVISIONS**

△	
△	
△	
△	
△	
△	
△	
△	
△	
△	

**PROJECT NUMBER** A17-077

**SHEET TITLE** TREE LIST, NOTES, AND DETAILS

**SHEET NUMBER**