

SITE PLAN
SCALE: 1" = 20'

PROVIDE SILT FENCE AROUND
NEW CONSTRUCTION

IF ANY ARCHEOLOGICAL
FINDINGS ARE UNCOVERED
DURING CONSTRUCTION,
THEY SHOULD BE PROTECTED
AND THE APPROPRIATE
AUTHORITIES NOTIFIED

MINIMUM LOT SIZE: 8,712 SQUARE FEET
MINIMUM LOT WIDTH: 60.0'
FRONT YARD SETBACK: 20.0'
MINIMUM SIDE YARD SETBACK: 3.0';
MAXIMUM SIDEYARD
SETBACK TOTAL: 12.0'
REAR YARD SETBACK: 15.0'

179+185 S RIVERVIEW STREET LOT COVERAGE
1 DWELLING UNIT
LOT: 16,742.6 SQUARE FEET
NEW ONE AND A HALF-STORY RESIDENCE:
2888.4 SQUARE FEET
DETACHED GARAGE: 832.0 SQUARE FEET
NEW PORCHES AND SCREEN PORCH:
1,072.2 SQUARE FEET
NEW DRIVEWAY, PATIO, AND SIDEWALK:
3,041.4 SQUARE FEET
FOOTPRINT: 8,330.4 SQUARE FEET
TOTAL LOT COVERAGE: 49.8%
ALLOWABLE COVERAGE: 50.0%

PRELIMINARY	BIDDING	CONSTRUCTION	REVISIONS
012720	000000	000000	000000

Kent + Amy Underwood
185 S. Riverview Street
Dublin, Ohio 43017



6065 Frantz Road . Suite 205
Dublin, Ohio 43017
614.774.2490 Phone
614.633.1053 Fax
simplifiedarchitecture.com



NEW ONE AND A HALF-STORY STRUCTURE:
 - CULTURED STONE VENEER
 - HARDIESHINGLES SHAKE SIDING
 - HARDEPLANK HORIZONTAL SIDING
 - 1X6 VERTICAL SIDING AT SUNROOM
 - 1X8 RAKE BOARD
 - 1X6 FRIEZE BOARD
 - 1X6 TRIM AT WINDOWS
 - TAPERED COLUMNS WITH CULTURED STONE BASE
 - ALUMINUM CLAD WINDOWS
 - COACH LIGHTS AT EXTERIOR DOORS
 - ASPHALT SHINGLES
 - WINDOWS TO INCLUDE PROJECTING SILLS BETWEEN THE CASING AND APRON

NEW DETACHED GARAGE STRUCTURE:
 - HARDIESHINGLES SHAKE SIDING
 - HARDEPLANK HORIZONTAL SIDING
 - 1X8 RAKE BOARD
 - 1X6 FRIEZE BOARD
 - 1X6 TRIM AT WINDOWS
 - ALUMINUM CLAD WINDOWS
 - COACH LIGHTS AT EXTERIOR DOORS
 - ASPHALT SHINGLES
 - WINDOWS TO INCLUDE PROJECTING SILLS BETWEEN THE CASING AND APRON

FRONT ELEVATION

SCALE: 1/8" = 1'-0"



NEW ONE AND A HALF-STORY STRUCTURE:
 - CULTURED STONE VENEER
 - HARDIESHINGLES SHAKE SIDING
 - HARDEPLANK HORIZONTAL SIDING
 - 1X8 RAKE BOARD
 - 1X6 FRIEZE BOARD
 - 1X6 TRIM AT WINDOWS
 - TAPERED COLUMNS WITH CULTURED STONE BASE
 - ALUMINUM CLAD WINDOWS
 - COACH LIGHTS AT EXTERIOR DOORS
 - ASPHALT SHINGLES
 - WINDOWS TO INCLUDE PROJECTING SILLS BETWEEN THE CASING AND APRON

RIGHT ELEVATION

SCALE: 1/8" = 1'-0"

012720	PRELIMINARY
000000	BIDDING
000000	CONSTRUCTION
000000	REVISIONS

Kent + Amy Underwood
 185 S. Riverview Street
 Dublin, Ohio 43017



6065 Frantz Road . Suite 205
 Dublin, Ohio 43017
 614.774.2490 Phone
 614.633.1053 Fax
 simplifiedarchitecture.com



- NEW ONE AND A HALF STORY STRUCTURE:
- CULTURED STONE VENEER
 - HARDIESHINGLES SHAKE SIDING
 - HARDEPLANK HORIZONTAL SIDING
 - 1X8 RAKE BOARD
 - 1X6 FRIEZE BOARD
 - 1X6 TRIM AT WINDOWS
 - TAPERED COLUMNS WITH CULTURED STONE BASE
 - ALUMINUM CLAD WINDOWS
 - COACH LIGHTS AT EXTERIOR DOORS
 - ASPHALT SHINGLES
 - WINDOWS TO INCLUDE PROJECTING SILLS BETWEEN THE CASING AND APRON

REAR ELEVATION

SCALE: 1/8" = 1'-0"



- NEW ONE AND A HALF STORY STRUCTURE:
- CULTURED STONE VENEER
 - HARDIESHINGLES SHAKE SIDING
 - HARDEPLANK HORIZONTAL SIDING
 - 1X6 VERTICAL SIDING AT SUNROOM
 - 1X8 RAKE BOARD
 - 1X6 FRIEZE BOARD
 - 1X6 TRIM AT WINDOWS
 - TAPERED COLUMNS WITH CULTURED STONE BASE
 - ALUMINUM CLAD WINDOWS
 - COACH LIGHTS AT EXTERIOR DOORS
 - ASPHALT SHINGLES
 - WINDOWS TO INCLUDE PROJECTING SILLS BETWEEN THE CASING AND APRON

LEFT ELEVATION

SCALE: 1/8" = 1'-0"

PRELIMINARY			
012720	000000	000000	000000
	BIDDING	CONSTRUCTION	REVISIONS

Kent + Amy Underwood
185 S. Riverview Street
Dublin, Ohio 43017



6065 Frantz Road . Suite 205
Dublin, Ohio 43017
614.774.2490 Phone
614.633.1053 Fax
simplifiedarchitecture.com

NEW DETACHED GARAGE STRUCTURE:
 - HARDIESHINGLES SHAKE SIDING
 - HARDEPLANK HORIZONTAL SIDING
 - 1X8 RAKE BOARD
 - 1X6 FRIEZE BOARD
 - 1X6 TRIM AT WINDOWS
 - ALUMINUM CLAD WINDOWS
 - COACH LIGHTS AT EXTERIOR DOORS
 - ASPHALT SHINGLES
 - WINDOWS TO INCLUDE PROJECTING SILLS BETWEEN THE CASING AND APRON



FRONT ELEVATION

SCALE: 1/8" = 1'-0"



LEFT ELEVATION

SCALE: 1/8" = 1'-0"

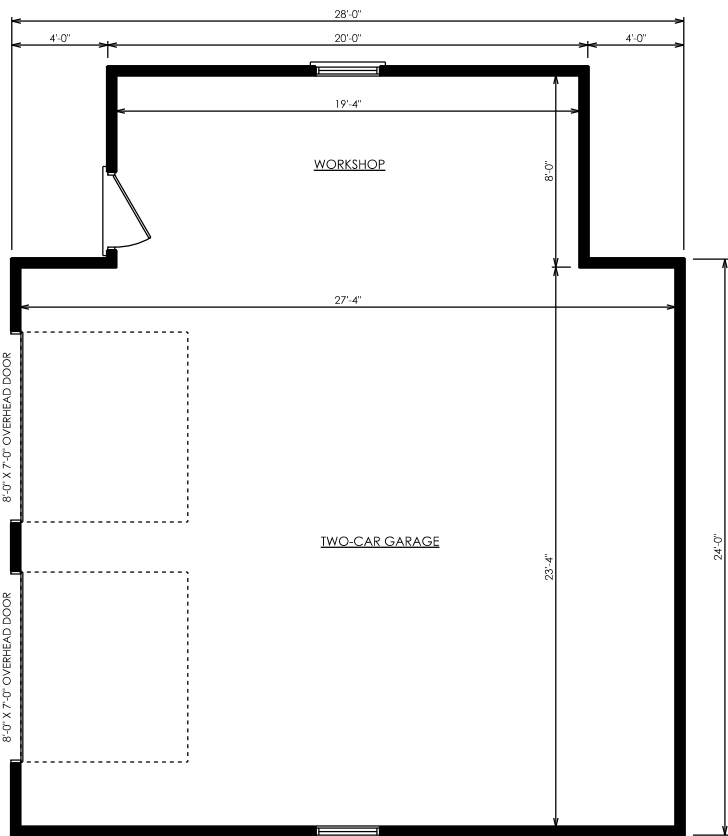

GARAGE FLOOR PLAN

SCALE: 1/8" = 1'-0"

832.0 SQUARE FEET



REAR ELEVATION

SCALE: 1/8" = 1'-0"



REAR ELEVATION

SCALE: 1/8" = 1'-0"

PRELIMINARY			
012720	000000	000000	000000
	BIDDING	CONSTRUCTION	REVISIONS

Kent + Amy Underwood
 185 S. Riverview Street
 Dublin, Ohio 43017

SIMPLIFIED LIVING
 ARCHITECTURE
 +
 DESIGN

6065 Frantz Road . Suite 205
 Dublin, Ohio 43017
 614.774.2490 Phone
 614.633.1053 Fax
 simplifiedarchitecture.com