

Franklin County Auditors Office

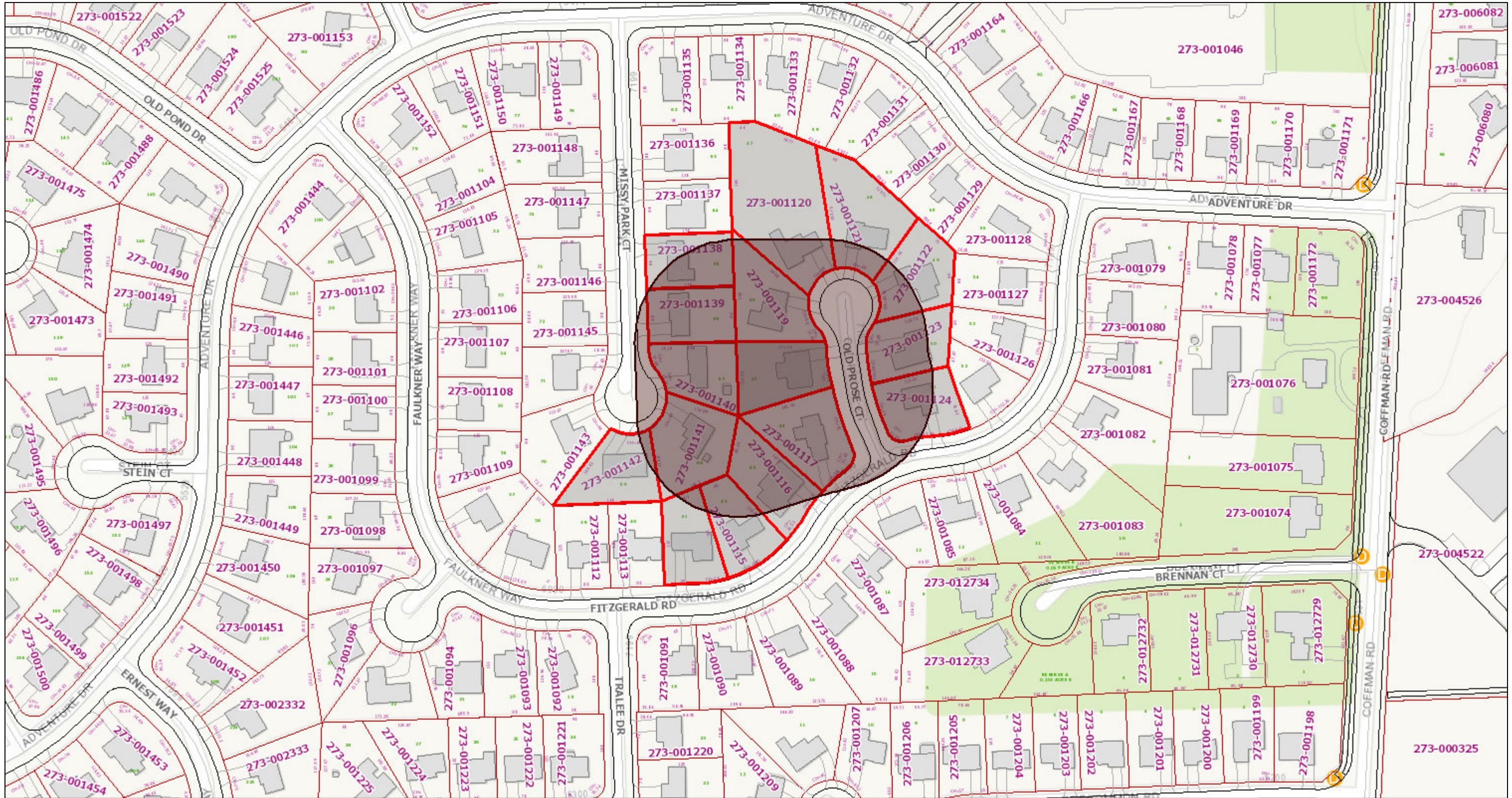

January 11, 2021

1:2,218

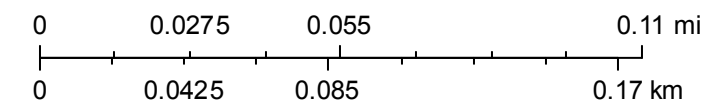

Franklin County Auditor
Sources: Esri, HERE, Garmin, Intermap, increment P Corp., GEBCO, USGS, FAO, NPS, NRCAN, GeoBase, IGN, Kadaster NL, Ordnance Survey, Esri Japan, METI, Esri China (Hong Kong), (c) OpenStreetMap contributors, and the GIS User Community

Minimum Side Yard Setback = 5-feet

Total Side Yard Setback (sum of two side yard setbacks) = 15-feet

Rear Yard Setback = 20 of lot depth = 28-feet (found by averaging lot lengths and taking 20)

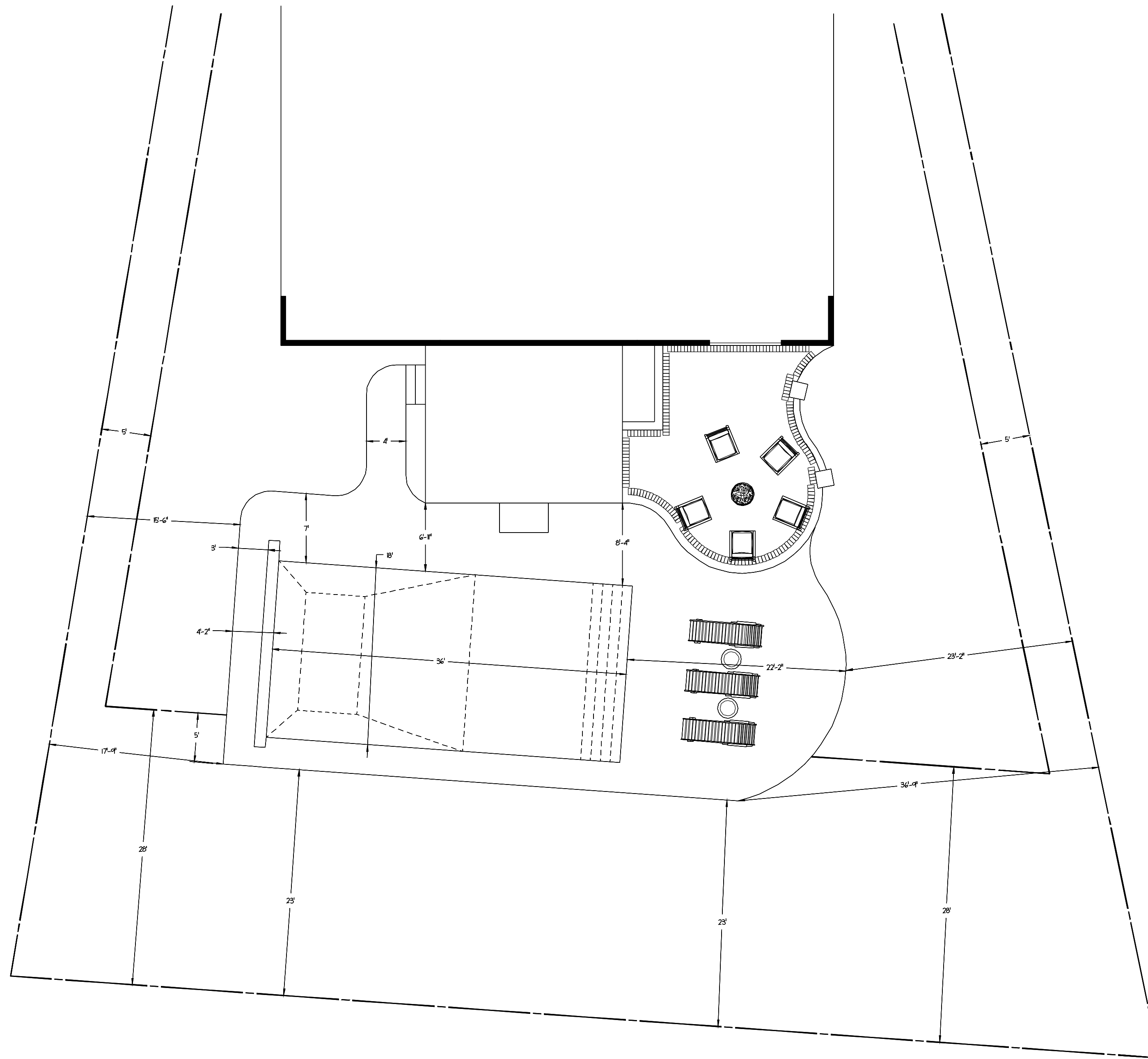

NOTES

No.	Date	Description



HAAS RESIDENCE
POOL DESIGN

JOHN HAAS
7099 OLD PROSE CT
DUBLIN, OH 43017

SCALE 1" = 8'
DRAWN BY CHAD
CHECKED BY BRYAN
DATE 7/28/20
DATE OF PRINT 7/28/20

PROJECT NO.
SHEET NO.

Minimum Side Yard Setback = 5-feet

Total Side Yard Setback (sum of two side yard setbacks) = 15-feet

Rear Yard Setback = 20 of lot depth = 28-feet (found by averaging lot lengths and taking 20)

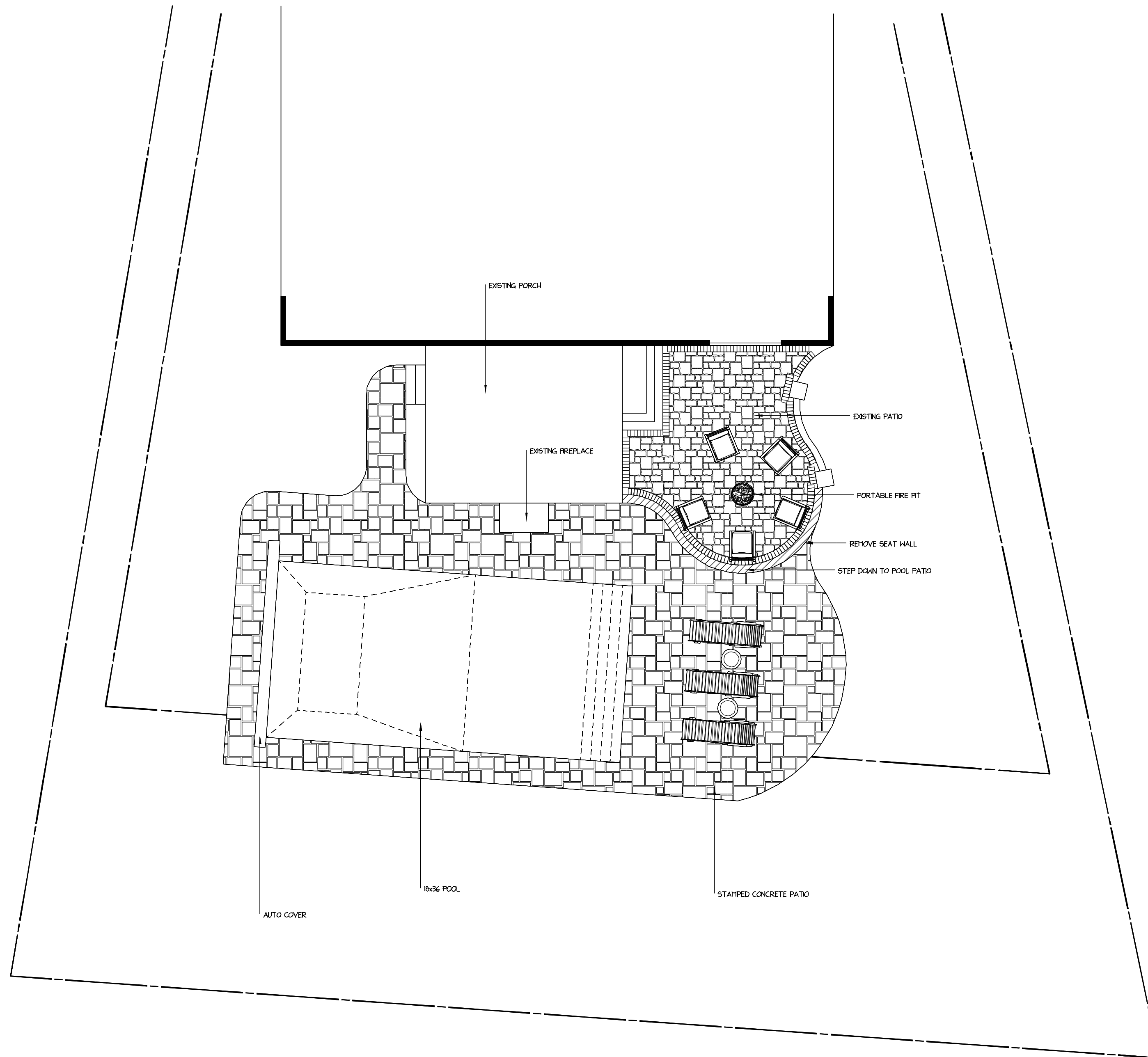

NOTES

No.	Date	Description

HAAS RESIDENCE
POOL DESIGN

JOHN HAAS
7099 OLD PROSE CT
DUBLIN, OH 43017

SCALE	1" = 8'
DRAWN BY	CHAD
CHECKED BY	BRYAN
DATE	7/28/20
DATE OF PRINT	7/28/20

PROJECT NO.	
SHEET NO.	