

J:\20211143\Drawings\45Sheets\Exhibits\Parking Count\Revised Concept\20211143-E-01-Parking Count(Phase 2).dwg. Last Saved By: Ivanover, 9/28/2022 8:56 AM Last Printed By: Ivanover, Linda, 9/28/2022 9:00 AM  
 Xrefs: 20211143-05-1000-05-E-20211143-CS-RRR-N-20211143-CS-RRR-05-E

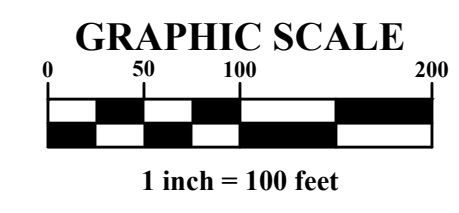
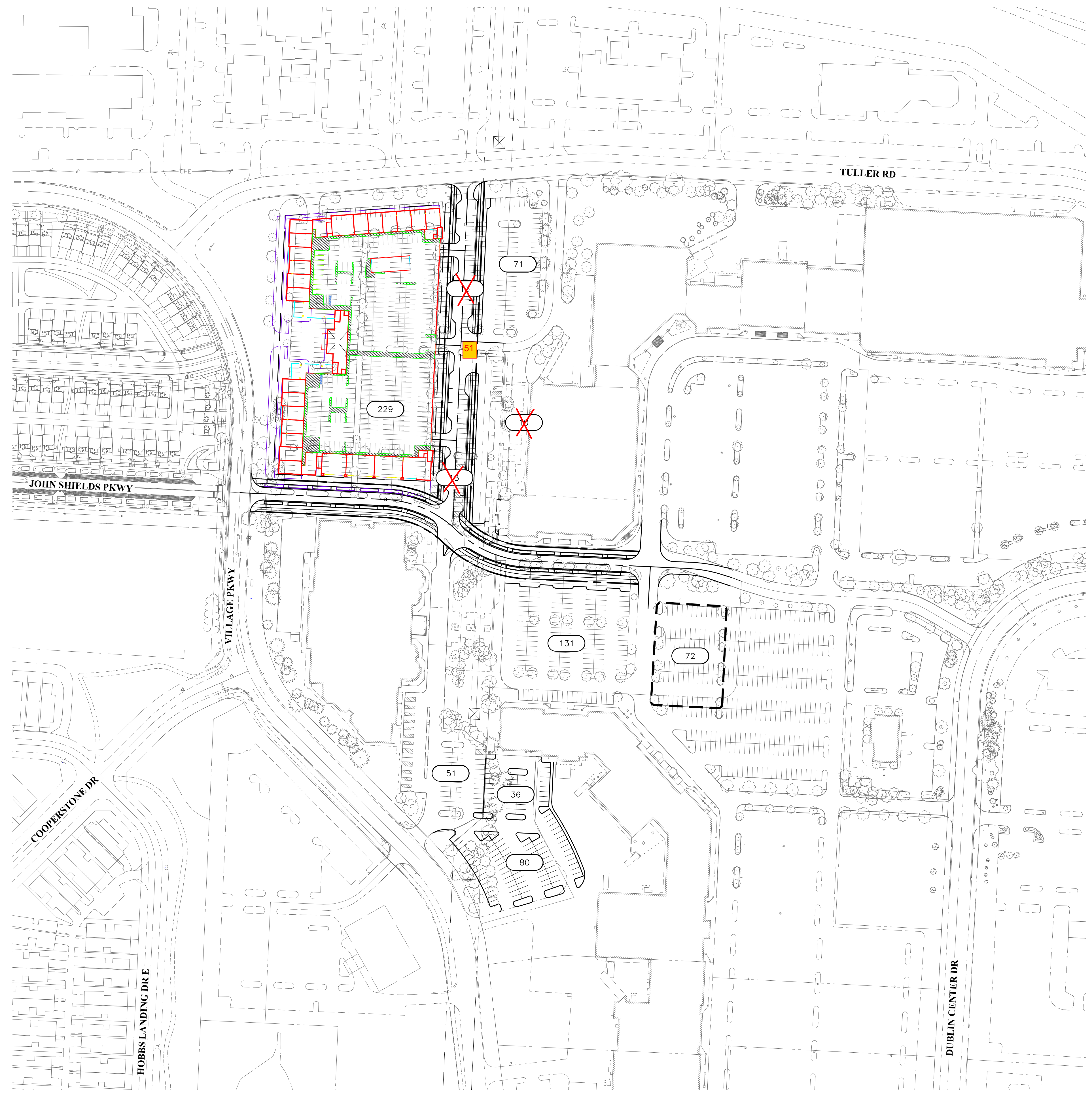

XXX = PARKING COUNT

PHASE 2 PARKING COUNT = ~~706~~  
721

MARK	DATE	DESCRIPTION	REVISIONS

**Stavroff**  
 STAVROFF LAND &  
 DEVELOPMENT, INC.

CITY OF DUBLIN, FRANKLIN COUNTY, OHIO  
 FOR  
**DUBLIN VILLAGE**  
**REDEVELOPMENT**  
 PARKING COUNT - PHASE 2



DATE  
 October, 2022

SCALE  
 1" = 100'

JOB NO.  
 20211143

SHEET

### **Dublin Village Parking Information**

- Per a reciprocal easement agreement with the owner of the AMC property we are obligated to provide the theater with 450 parking spaces in and around the center. This will be accomplished with reserving spaces within various existing parking lots, on-street parking, new or reworked parking lots, and within the public portion of the parking garage associated with the corridor building project.
- The center currently has 2,500+/- parking spaces throughout the development at a rate of approximately 7.6/1,000 square feet. If anything, we have a parking problem in which we are over parked. With this project will be removing 448+/- existing parking spaces. However, we are adding back a total of 608+/- parking spaces of which 483+/- will be located in the garage, 81+/- off-site in a surface lot and 44+/- on-street spaces replaced.
- Based on our unit mix our analysis shows we must provide 412+/- parking spaces per code to satisfy the parking for this building. Given we have a total of 608+/- spaces we have 196+/- excess spaces as part of this project.